

WATER AND SEWER NOTES

1. ALL NEW WATER AND SEWER CONNECTIONS SHALL BE COORDINATED WITH THE TOWN OF CHRISTIANBURG.
2. THE CONTRACTOR SHALL BE RESPONSIBLE FOR NOTIFYING THE OWNER, THE TOWN OF CHRISTIANBURG AND THE ENGINEER OF ANY CHANGES OR UNANTICIPATED CONDITIONS ENCOUNTERED WHILE PERFORMING THE WORK SHOWN HEREON.
3. THE CONTRACTOR SHALL VISIT THE SITE AND VERIFY EXISTING CONDITIONS PRIOR TO STARTING CONSTRUCTION.
4. THE CONTRACTOR SHALL VERIFY THE LOCATIONS OF ALL EXISTING UTILITIES PRIOR TO STARTING CONSTRUCTION.
5. THE NEW SANITARY SEWER TAP SHALL BE PERFORMED BY THE CONTRACTOR UNDER SUPERVISION BY THE TOWN OF CHRISTIANBURG.
6. THE NEW WATERLINE TAP SHALL BE PERFORMED BY THE CONTRACTOR UNDER SUPERVISION BY THE TOWN OF CHRISTIANBURG.

APPROVED: Engineering _____ Date _____

APPROVED: Planning _____ Date _____

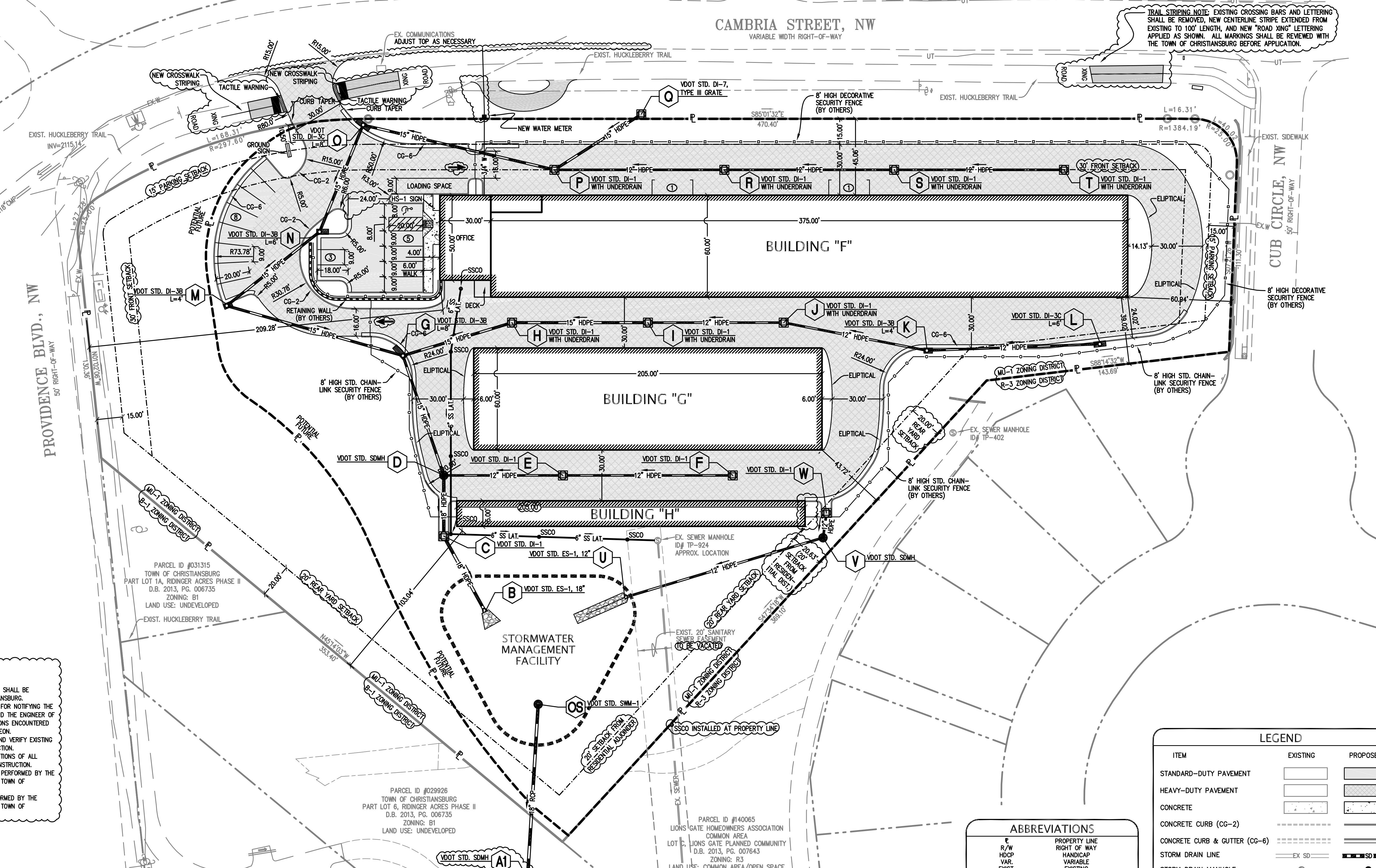
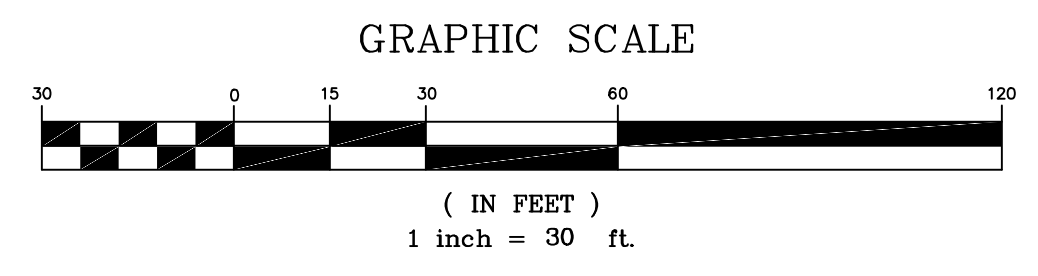

TRAIL STRIPING NOTE: EXISTING CROSSING BARS AND LETTERING SHALL BE REMOVED, NEW CENTERLINE STRIPE EXTENDED FROM EXISTING TO 100' LENGTH, AND NEW "ROAD XING" LETTERING APPLIED AS SHOWN. ALL MARKINGS SHALL BE REVIEWED WITH THE TOWN OF CHRISTIANBURG BEFORE APPLICATION.

ABBREVIATIONS

R/W	RIGHT OF WAY
HDCP	HANDICAP
VAR.	VARIABLE
EXIST.	EXISTING
TYP.	TYPICAL
HDPE	HIGH-DENSITY POLYETHYLENE PIPE
RCP	REINFORCED CONCRETE PIPE
SD	STORM DRAIN
SDCO	STORM DRAIN CLEANOUT
SDMH	STORM DRAIN MANHOLE
SS	SANITARY SEWER
SSMH	SANITARY SEWER MANHOLE
STD.	STANDARD
W	WATER LINE
TC	TOP OF CURB
EP	EDGE OF PAVEMENT
RE	RISE ELEVATION
SP	SPOT ELEVATION
BW	BOTTOM OF WALL
TW	TOP OF WALL
CO	SANITARY SEWER CLEANOUT TO BE REMOVED
UE	UNDERGROUND ELECTRIC
UG	UNDERGROUND GAS

LEGEND

ITEM	EXISTING	PROPOSED
STANDARD-DUTY PAVEMENT	[Symbol]	[Symbol]
HEAVY-DUTY PAVEMENT	[Symbol]	[Symbol]
CONCRETE	[Symbol]	[Symbol]
CONCRETE CURB (CG-2)	[Symbol]	[Symbol]
CONCRETE CURB & GUTTER (CG-6)	[Symbol]	[Symbol]
STORM DRAIN LINE	[Symbol]	[Symbol]
STORM DRAIN MANHOLE	[Symbol]	[Symbol]
SANITARY SEWER LINE	[Symbol]	[Symbol]
WATERLINE	[Symbol]	[Symbol]
UTILITY POLE	[Symbol]	[Symbol]
OVERHEAD ELECTRIC LINE	[Symbol]	[Symbol]
OVERHEAD TELEPHONE LINE	[Symbol]	[Symbol]
INDEX CONTOURS	[Symbol]	[Symbol]
INTERMEDIATE CONTOURS	[Symbol]	[Symbol]
UNDERGROUND GAS	[Symbol]	[Symbol]
OVERHEAD ELECTRIC	[Symbol]	[Symbol]
SPOT ELEVATION	[Symbol]	[Symbol]

Lumsden Associates, P.C.
ENGINEERS | SURVEYORS | PLANNERS

4664 BRAMBLETON AVENUE
P.O. BOX 20669
ROANOKE, VIRGINIA 24018

PHONE: (540) 774-4411
FAX: (540) 772-9445
WWW.LUMSDENPC.COM

COMMONWEALTH OF VIRGINIA
HOWARD P. BOGGS II
Lic. No. 000930
6/1/19
LANDSCAPE ARCHITECT

DIMENSIONAL LAYOUT

SITE DEVELOPMENT PLAN FOR
CAMBRIA POINTE EXPANSION
PREPARED FOR
VIRGINIA VARSITY STORAGE, INC.
SITUATED AT 4000 CAMBRIA STREET
TOWN OF CHRISTIANBURG, VIRGINIA

REVISIONS

NO.	DATE	DESCRIPTION

DATE: June 1, 2019
SCALE: 1" = 30'
COMMISSION NO: 18-252
SHEET 4 OF 19