

LINE	BEARING	DISTANCE
L1	S88°16'55"W	16.89
L2	S81°42'04"E	83.24
L3	N83°32'56"E	83.24
L4	N88°47'05"E	16.89
L5	N83°32'56"E	16.70
L6	N83°32'56"E	16.70
L7	N88°47'05"E	20.78
L8	S81°42'04"E	16.70
L9	N81°21'03"W	89.79
L10	S88°16'55"W	81.00
L11	S81°42'04"E	81.00
L12	S88°16'55"W	16.89
L13	S81°42'04"E	16.89
L14	S88°16'55"W	16.89
L15	S81°42'04"E	16.89
L16	S88°16'55"W	16.89
L17	S81°42'04"E	16.89

CURVE	ARC LENGTH	RADIUS	DELTA ANGLE	CHORD BEARING	CHORD LENGTH
C1	83.24	250.00	83.2624	N57.8874E	83.24
C2	16.89	21.00	84.2814	S88.0811E	2.23
C3	16.89	21.00	95.7186	N88.0811E	2.23
C4	16.89	21.00	90.0101	S88.0811E	2.23
C5	16.89	21.00	90.0101	S88.0811E	2.23
C6	16.89	21.00	84.2814	S88.0811E	2.23
C7	16.89	21.00	84.2814	S88.0811E	2.23
C8	16.89	21.00	84.2814	S88.0811E	2.23
C9	16.89	21.00	84.2814	S88.0811E	2.23
C10	16.89	21.00	84.2814	S88.0811E	2.23
C11	16.89	21.00	84.2814	S88.0811E	2.23
C12	16.89	21.00	84.2814	S88.0811E	2.23
C13	16.89	21.00	84.2814	S88.0811E	2.23
C14	16.89	21.00	84.2814	S88.0811E	2.23
C15	16.89	21.00	84.2814	S88.0811E	2.23
C16	16.89	21.00	84.2814	S88.0811E	2.23
C17	16.89	21.00	84.2814	S88.0811E	2.23
C18	16.89	21.00	84.2814	S88.0811E	2.23
C19	16.89	21.00	84.2814	S88.0811E	2.23
C20	16.89	21.00	84.2814	S88.0811E	2.23

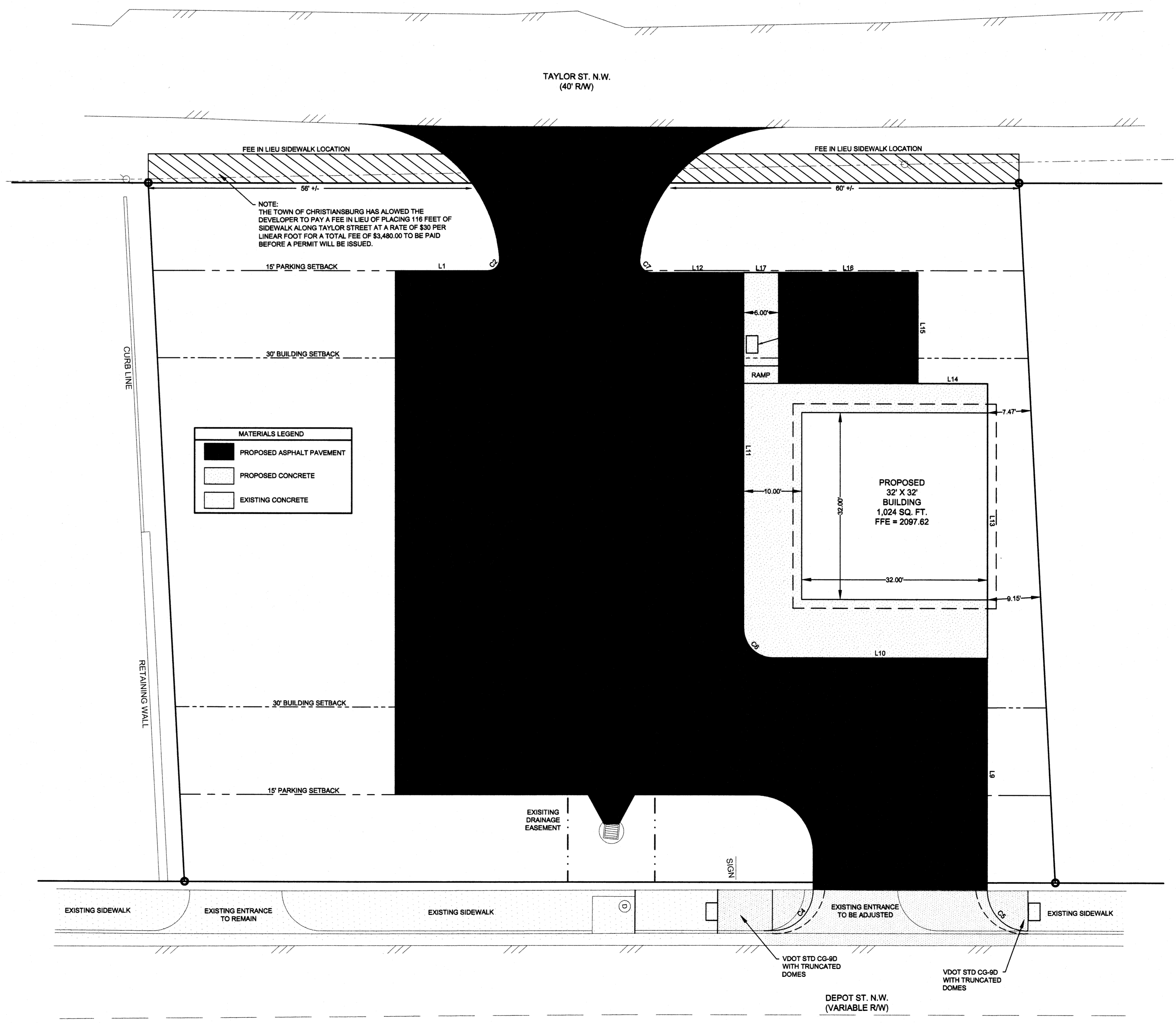
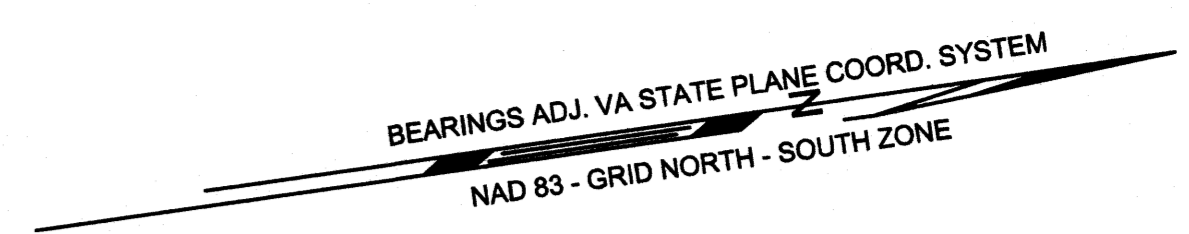

[Signature] 20 Nov 2
PLANNING DATE

[Signature] 11/18/21
ENGINEERING DATE

FINK ENGINEERING & LAND SURVEYING, LLC
16 EAST MAIN ST.
PRINCETON, WV 24740
414 THORN ST.
CHRISTIANBURG, VA 24073
304-425-1605
940-381-2626

CHECKED BY: RBF	CHECKED BY: RBF
DATE: 09-23-19	DATE: 09-23-19
DESIGNED BY: RBF	DESIGNED BY: RBF
DATE: 09-23-19	DATE: 09-23-19
SCALE: 1" = 10'	
SHEET: C202	

POPPYS, LLC
PROPOSED DEVELOPMENT
317 DEPOT STREET NW
TOWN OF CHRISTIANBURG VIRGINIA
DIMENSIONAL PLAN

DATE	APPROVED	RELEASED FOR	REASON FOR RELEASE
01-08-20	RBF	TOWN REVIEW	
05-11-20	RBF	FOR CONSTRUCTION	

CLIENT: T. WILLIAMS
FELS JOB #: 061719

COMMONWEALTH OF VIRGINIA
[Signature]
RONALD B. FINK
Lic. No. 043639
05/11/20
PROFESSIONAL ENGINEER

