

PAVEMENT MARKING NOTES:

- STANDARD PARKING STRIPING: SURFACES SHOULD BE CLEAN AND DRY STRIPING SHALL BE 4" WIDE, COLOR WHITE
- HANDICAP PARKING STRIPING: SURFACES SHOULD BE CLEAN AND DRY STRIPING SHALL BE 4" WIDE, COLOR "HANDICAP BLUE"
- HANDICAP SYMBOL : SURFACES SHOULD BE CLEAN AND DRY SYMBOL SHALL BE MIN. 36"x36" SIZE, COLOR "HANDICAP BLUE"

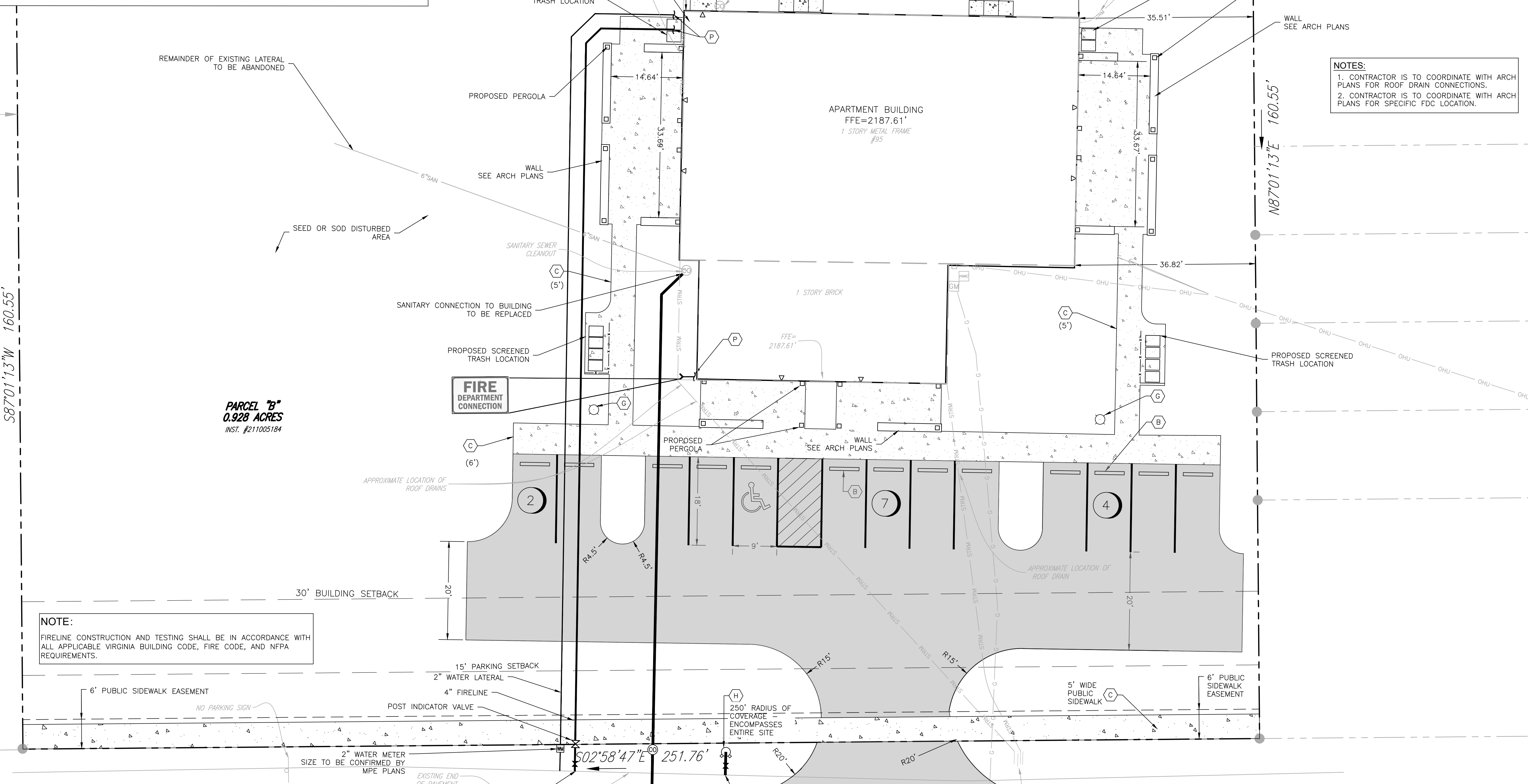

- LEGEND**
- CONCRETE WALK
 - AREA LIGHT POLE
 - FIRE HYDRANT ASSEMBLY
 - CONNECTION BY PLUMBER
 - CONCRETE
 - ASPHALT PAVING
 - PARKING STRIPING

- UTILITY NOTES**
- G.C. SHALL COORDINATE THE EXACT SANITARY SEWER AND DOMESTIC WATER LATERAL BUILDING TIE IN LOCATIONS WITH THE ARCHITECTURAL PLANS AND MAINTAIN SEPARATION NOTED IN THE TOWN OF CHRISTIANBURG WATERLINE DESIGN AND CONSTRUCTION STANDARDS.
 - THE G.C. IS RESPONSIBLE FOR PROVIDING AND INSTALLING ALL CONDUIT ASSOCIATED WITH REQUIRED UTILITIES FOR THE PROPOSED BUILDING AND ANY NECESSARY UTILITIES ON-SITE SUCH AS LIGHTING, ELECTRICAL, ETC.
 - THE G.C. SHALL COORDINATE TEMPORARY POWER FOR THE PROPOSED BUILDINGS.
 - SANITARY WASTE LINES FROM BUILDING SHALL BE A MINIMUM 4" PVC (MIN. SLOPE 2.08%) OR 6" PVC (MIN. SLOPE 1.04%). SEE ARCHITECTURALS.
 - THE FIRE HYDRANT BONNET SHALL BE PAINTED ORANGE.

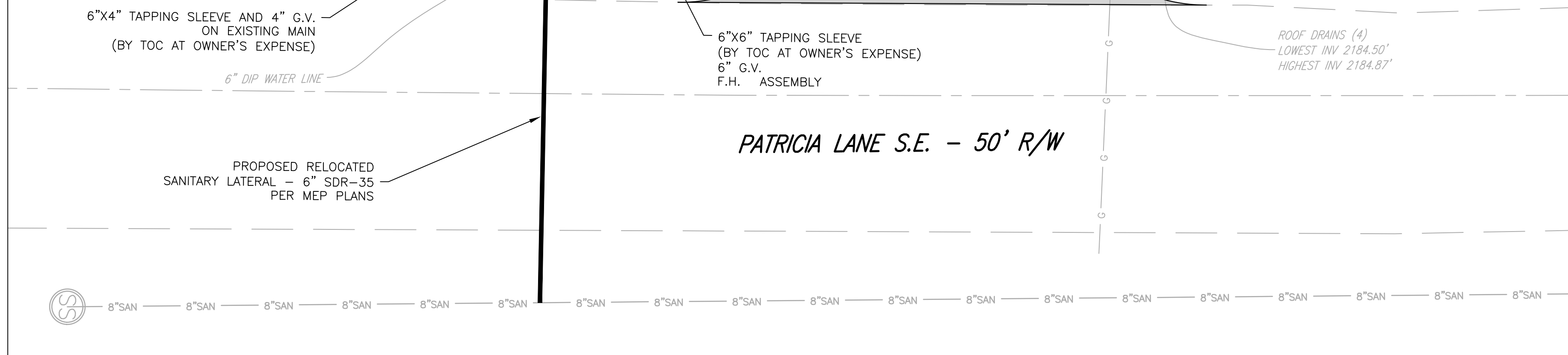

APPROVED: Engineering _____ Date _____

APPROVED: Planning _____ Date _____

Scale: 1" = 10'

North Arrow

NOTE:
FIRELINE CONSTRUCTION AND TESTING SHALL BE IN ACCORDANCE WITH ALL APPLICABLE VIRGINIA BUILDING CODE, FIRE CODE, AND NFPA REQUIREMENTS.

PARCEL "B"
0.928 ACRES
INST. #211005184

S87°01'13"W 160.55'

N02°58'47"W 251.76'

N87°01'13"E 160.55'

PATRICIA LANE S.E. - 50' R/W

APARTMENT BUILDING
FFE=2187.61'
1 STORY METAL FRAME
#95

1 STORY BRICK

FFE=2187.61'

SEE ARCH PLANS

SEE ARCH PLANS

250' RADIUS OF COVERAGE ENCOMPASSES ENTIRE SITE

ROOF DRAINS (4)
LOWEST INV 2184.50'
HIGHEST INV 2184.87'

NOTES:
1. CONTRACTOR IS TO COORDINATE WITH ARCH PLANS FOR ROOF DRAIN CONNECTIONS.
2. CONTRACTOR IS TO COORDINATE WITH ARCH PLANS FOR SPECIFIC FDC LOCATION.

BALZER & ASSOCIATES
PLANNERS / ARCHITECTS
ENGINEERS / SURVEYORS

Roanoke / Richmond
New River Valley
Shenandoah Valley

www.balzer.cc
80 College Street
Suite H
Christiansburg, VA 24073
540.381.4290

STEVEN M. SEMONES
Lic. No. 962
08/31/2022
LANDSCAPE ARCHITECT

PATRICIA LANE APARTMENTS
95 PATRICIA LANE SE
LAYOUT & UTILITY PLAN

SHAMSVILLE MAGISTERIAL DISTRICT
TOWN OF CHRISTIANBURG, VIRGINIA

DRAWN BY: SJW
DESIGNED BY: SJW
CHECKED BY: SMS
DATE: 04/05/2022
SCALE: 1" = 10'
REVISIONS:
8/10/2022
8/31/2022

C4
PROJECT NO. 24220025.00