

CONSTRUCTION NOTES:

- CONSTRUCTION SHALL BE IN ACCORDANCE WITH THE AMERICANS WITH DISABILITIES ACT (ADA).
- CONSTRUCTION TRAILER, FENCING, PARKING, AND STAGING AREAS SHALL BE COORDINATED WITH AND APPROVED BY THE OWNER.
- MAINTAIN EMERGENCY, SERVICE, AND DELIVERY VEHICLE ACCESS TO THE SURROUNDING AREA AND COORDINATE THIS WITH THE OWNER.
- MOST RECENT OSHA TRENCHING STANDARDS SHALL APPLY ON THIS PROJECT.
- WORK IN THE VDOT RIGHT-OF-WAY WILL REQUIRE A VDOT PERMIT. A PERMIT FEE AND BOND WILL BE REQUIRED.
- COORDINATE WITH VDOT FOR RE-INSTALLATION OF SIGNS SHOWN TO BE REMOVED.
- CURB RADI SHALL BE 3' UNLESS NOTED OTHERWISE ON PLANS.
- AT TERMINUS OF CG-2 CURB, TAPER CURB REVEAL FROM FULL 6" CURB DOWN TO FLUSH WITH ASPHALT GRADE OVER 2'.

PAVING NOTES:

- SITE CONCRETE SHALL COMPLY WITH STD. DETAIL CP-1. CONTROL JOINTS SHALL BE INSTALLED EVERY 4' (MAX), AND EXPANSION JOINTS SHALL BE INSTALLED EVERY 20' (MAX) UNLESS OTHERWISE NOTED. DOWELS SHALL BE INSTALLED AT EXPANSION JOINTS. INSTALL TURN DOWN CONCRETE CROSS SECTION FOR SIDEWALK WHERE IT ABUTS THE BUILDING PAD & WHERE FLUSH WITH PAVEMENT.
- ASPHALT PAVING SHALL COMPLY WITH STD. DETAIL AP-1. WHERE NEW PAVEMENT IS INSTALLED ADJACENT TO EXISTING PAVEMENT, EXISTING PAVEMENT SHALL BE SAW CUT 1' BACK FROM THE EXISTING EDGE AND PRIMED WITH VDOT APPROVED PRIMER PRIOR TO PLACEMENT OF NEW ASPHALT MATERIAL.
- ALL PAVEMENT STRIPING AND ROADWAY SIGNAGE SHALL BE IN ACCORDANCE WITH THE LATEST VERSION OF THE MANUAL OF UNIFORM TRAFFIC CONTROL DEVICES (MUTCD).
- FOR THE PAVEMENT SAWCUT/DEMO ALONG NORTH FRANKLIN STREET PLEASE PROVIDE THE FOLLOWING: "PAVEMENT TIE-IN SHALL BE IN ACCORDANCE WITH VDOT STANDARD DETAIL WP-2. PAVEMENT SHALL BE SAWCUT TO PROVIDE CLEAN VERTICAL LINE TO FULL DEPTH OF ASPHALT AT WHITE EDGE LINE. CONTRACTOR SHALL MILL SURFACE MIX PAVEMENT A MINIMUM 12" PAST SAWCUT TO ERADICATE EDGE LINE AND OVERLAP BASE MIX ASPHALT."

GENERAL UTILITY NOTES:

- LOCATION OF EXISTING UNDERGROUND UTILITIES ARE APPROXIMATE BASED ON AVAILABLE ABOVEGROUND STRUCTURES (VALVES, MANHOLES, ETC.). FIELD VERIFY ALL EXISTING UTILITIES TO DETERMINE THAT FINAL UTILITY ARRANGEMENTS SHOWN ON THE PLANS ARE FEASIBLE PRIOR TO ORDERING MATERIALS. IF LOCATIONS OF EXISTING UTILITIES ARE FOUND TO BE IN LOCATIONS OTHER THAN THOSE INDICATED ON PLANS, CONTACT THE OWNER IN A TIMELY MANNER TO DETERMINE IF PLAN MODIFICATIONS ARE REQUIRED.
- UTILITY SERVICE MUST BE MAINTAINED THROUGHOUT CONSTRUCTION. SERVICE SHALL NOT BE INTERRUPTED WITHOUT PRIOR APPROVAL FROM THE OWNER. APPROVED PERIODS OF INTERRUPTED SERVICE SHALL BE MINIMIZED IN DURATION AND SHALL BE COORDINATED WITH THE OWNER AND UTILITY PROVIDER.
- FIELD VERIFY LOCATION AND SIZE OF EXISTING UTILITIES AT THEIR CONNECTION TO UTILITIES SHOWN ON THE PLANS AS A FIRST STEP TO SITE UTILITY CONSTRUCTION.
- SITE SEWER SERVICE IS VIA PUMP SYSTEM IN THIS VAULT. FORCE MAIN CONNECTS TO TOWN MANHOLE S.W. OF THIS SITE. EXACT LOCATION AND ROUTE OF FORCE MAIN IS UNKNOWN.
- COORDINATE WITH TOWN OF CHRISTIANBURG TO PROVIDE MATERIALS FOR AND MAKE TAP ON WATER AUTHORITY MAIN AT DEVELOPER'S EXPENSE. WATER AUTHORITY TO OBSERVE TAP.
- RELOCATE WATER METER TO NEW 6" LINE AS SHOWN. NEW 1 INCH METER, NEW BOX, AND MATERIALS BY TOWN OF CHRISTIANBURG AT OWNERS EXPENSE. CONTRACTOR TO CONNECT NEW 1.5 INCH SERVICE LINE TO BUILDING FROM NEW METER.
- FIRE HYDRANT SHALL BE AMERICAN DARLING 5-1/4" BARREL MODEL B-84-B OR APPROVED EQUAL. REFERENCE TOWN WATER SPECIFICATIONS.
- GATE VALVES SHALL BE MUELLER 2361 SERIES OR APPROVED EQUAL, INCLUDING POST INDICATOR GATE VALVE. REFERENCE TOWN WATER SPECIFICATIONS.
- INDICATOR POST SHALL BE MUELLER A-20806 OR APPROVED EQUAL. REFERENCE MECHANICAL PLANS FOR INFORMATION REGARDING SUPERVISORY / TAMPER SWITCH AND CONNECTION TO FIRE PANEL.
- EXISTING SIGNAL PULL BOX SHALL BE LEFT IN PLACE AND A NEW LARGER BOX INSTALLED ON TOP. TOP OF NEW BOX TO BE FLUSH WITH SIDEWALK. PROVIDE A 6" MINIMUM (DEPTH AND WIDTH) CONCRETE COLLAR AROUND THE NEW BOX WHERE NOT ENCOMPASSED BY SIDEWALK.

GENERAL CONSTRUCTION NOTES:

- STRUCTURAL ENGINEERING DESIGN AND DETAILS FOR SEGMENTAL BLOCK WALL TO BE PROVIDED BY WALL MANUFACTURER AS PART OF WALL SYSTEM, INCLUDING REQUIRED PEDESTRIAN GUARD RAILINGS. DESIGN DOCUMENTS SHALL BE SEALED BY A PROFESSIONAL ENGINEER AND SUBMITTED TO THE TOWN OF CHRISTIANBURG FOR REVIEW PRIOR TO CONSTRUCTION.

TRAFFIC SIGNAGE

- PROVIDE 30" R5-1 "DO NOT ENTER" SIGNS WITH 2" (14 GA.) SQUARE TUBE POST.
- PROVIDE 24" R3-2 "NO LEFT TURN" SYMBOL SIGN WITH 2" (14 GA.) SQUARE TUBE POST.
- NEW POST/FOUNDATION SHALL BE PROVIDED BY CONTRACTOR PER VDOT STANDARD DETAIL STP-1, TYPE A (PLATE 1321.13 FROM ROAD AND BRIDGE STANDARDS).

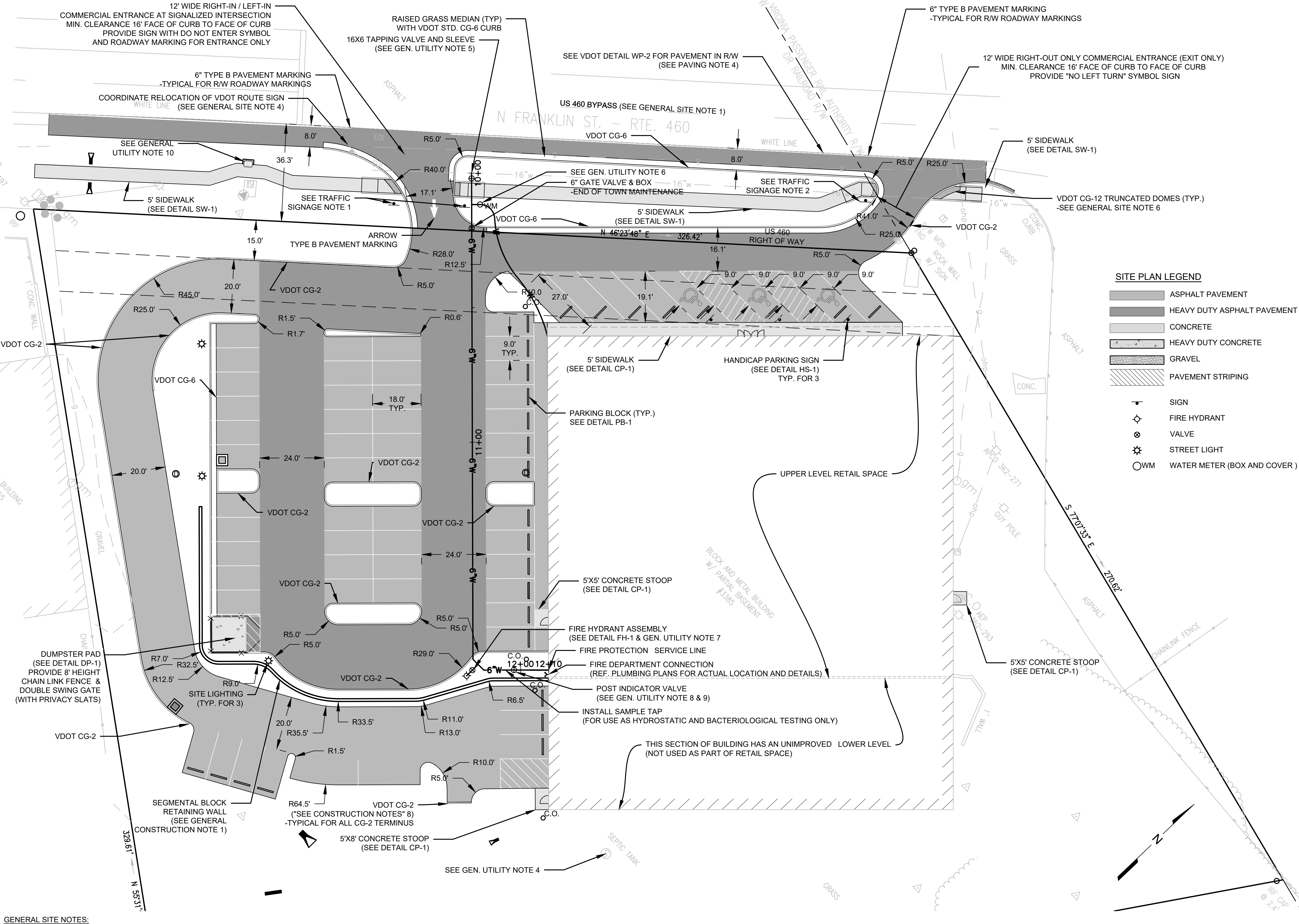

SITE PLAN LEGEND

- | | |
|--|-----------------------------|
| | ASPHALT PAVEMENT |
| | HEAVY DUTY ASPHALT PAVEMENT |
| | CONCRETE |
| | HEAVY DUTY CONCRETE |
| | GRAVEL |
| | PAVEMENT STRIPING |
| | SIGN |
| | FIRE HYDRANT |
| | VALVE |
| | STREET LIGHT |
| | WATER METER (BOX AND COVER) |

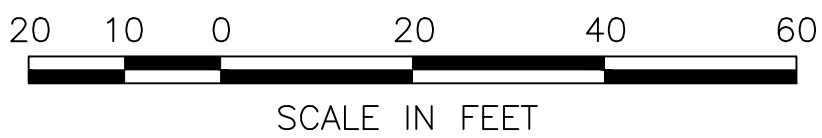

SITE PLAN
CHARLES TONEY PROPERTY
3385 NORTH FRANKLIN ST
CHRISTIANSBURG, VA

PROJECT NO.	20220927
LAT.	37.175895°
LONG.	80.417707° W
DATE:	15 MAR 2023
DRAWN BY:	BEC
CHECKED BY:	MTC

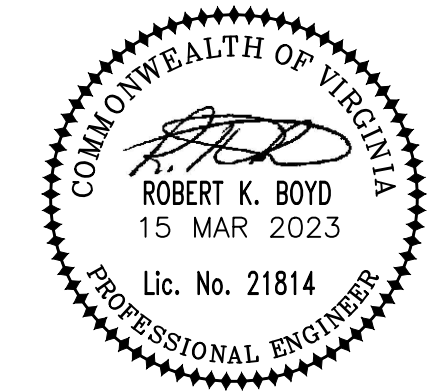

REV. 1	6 JUL 2023
REV. 2	24 AUG 2023

SITE PLAN

HURT&PROFFITT

SHEET NO.	REV.
C301	