



Roanoke / Richmond
New River Valley
Shenandoah Valley
www.balzer.cc
80 College Street
Suite H
Christiansburg, VA 24073
540.381.4290



CARTER MACHINERY

2095 ROANOKE STREET, CHRISTIANSBURG, VA 24073

TEMPORARY SITE PLAN - PHASING EXHIBIT B

SHAWSVILLE MAGISTERIAL DISTRICT, MONTGOMERY COUNTY, VIRGINIA 24073
TOWN OF CHRISTIANSBURG

| | |
|-------------|------------|
| DRAWN BY | JJH/ACN |
| DESIGNED BY | JJH/ACN |
| CHECKED BY | JRT |
| DATE | 04/30/2024 |
| SCALE | 1" = 30' |
| REVISIONS | |
| 06/10/2024 | |
| 07/18/2024 | |

TEMP-3

PHASING EXHIBIT NOTE:
IMPROVEMENTS SHOWN IN PHASING EXHIBIT A THROUGH C ARE FOR INFORMATIONAL PURPOSES ONLY RELATED TO THE SEPARATION AND SEQUENCING OF CONSTRUCTION AND TEMPORARY BUSINESS OPERATIONS. PLEASE REFER TO THE FULL DESIGN PLANS AND SPECIFICATIONS PERMITTED SEPARATELY UNDER THE TOWN OF CHRISTIANBURG LAND DISTURBANCE PERMIT. THE GRADING, IMPROVEMENTS, AND EROSION AND SEDIMENT CONTROL MEASURES SHOWN HEREON REQUIRE ISSUANCE OF THE LAND DISTURBANCE PERMIT PRIOR TO CONSTRUCTION.

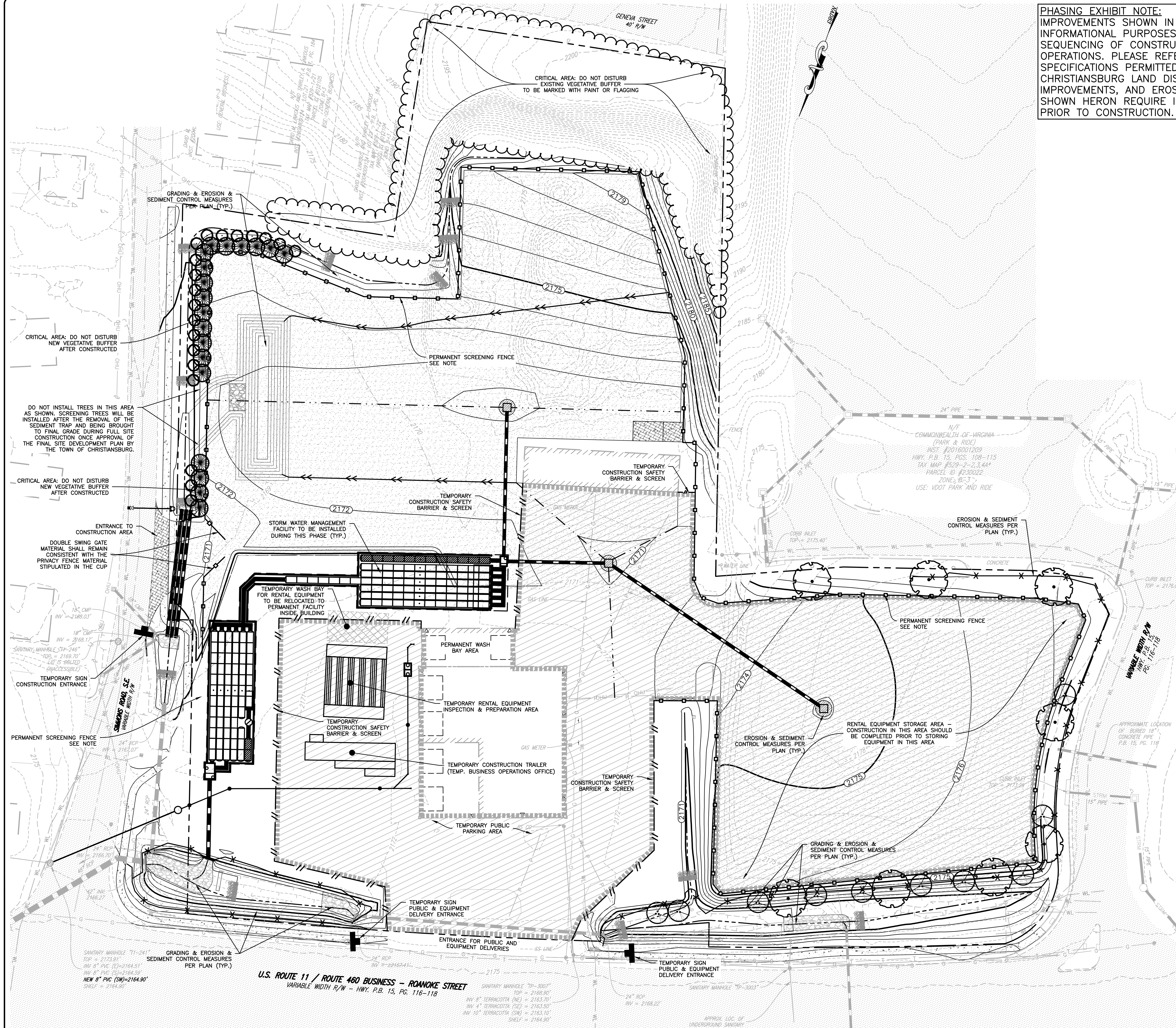

LEGEND

AREA OF TEMPORARY
BUSINESS OPERATIONS

NOTE

1. PERMANENT SCREENING FENCE & LANDSCAPING TO BE INSTALLED IN ACCORDANCE WITH THE CUP CONDITIONS. INSTALL EXTENTS OF PERMANENT SCREENING FENCE AND LANDSCAPING ALONG WITH GRADING AS NECESSARY FOR INSTALLATION PRIOR TO PROGRESSING TO THE REMAINDER OF CONSTRUCTION OPERATIONS AS SHOWN ON THIS SHEET. REFER TO THE CONDITIONAL USE PERMIT APPLICATION FOR SPECIFICATIONS.

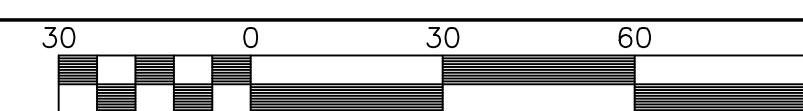
$$1'' = 30$$

APPROVED: Engineering

Date _____

APPROVED: Planning

Date _____