



Roanoke / Richmond
New River Valley
Shenandoah Valley
www.balzer.cc
80 College Street
Suite H
Christiansburg, VA 24073
540.381.4290

CARTER MACHINERY

2095 ROANOKE STREET, CHRISTIANSBURG, VA 24073

TEMPORARY SITE PLAN - PHASING EXHIBIT B

SHAWSVILLE MAGISTERIAL DISTRICT, MONTGOMERY COUNTY, VIRGINIA 24073
TOWN OF CHRISTIANSBURG

DRAWN BY	JJH/ACN
DESIGNED BY	JJH/ACN
CHECKED BY	JRT
DATE	04/30/2024
SCALE	1" = 30'
REVISIONS	
06/10/2024	
07/18/2024	
08/08/2024	

TEMP-3

PHASING EXHIBIT NOTE:
IMPROVEMENTS SHOWN IN PHASING EXHIBIT A THROUGH C ARE FOR INFORMATIONAL PURPOSES ONLY RELATED TO THE SEPARATION AND SEQUENCING OF CONSTRUCTION AND TEMPORARY BUSINESS OPERATIONS. PLEASE REFER TO THE FULL DESIGN PLANS AND SPECIFICATIONS PERMITTED SEPARATELY UNDER THE TOWN OF CHRISTIANBURG LAND DISTURBANCE PERMIT. THE GRADING, IMPROVEMENTS, AND EROSION AND SEDIMENT CONTROL MEASURES SHOWN HEREON REQUIRE ISSUANCE OF THE LAND DISTURBANCE PERMIT PRIOR TO CONSTRUCTION.

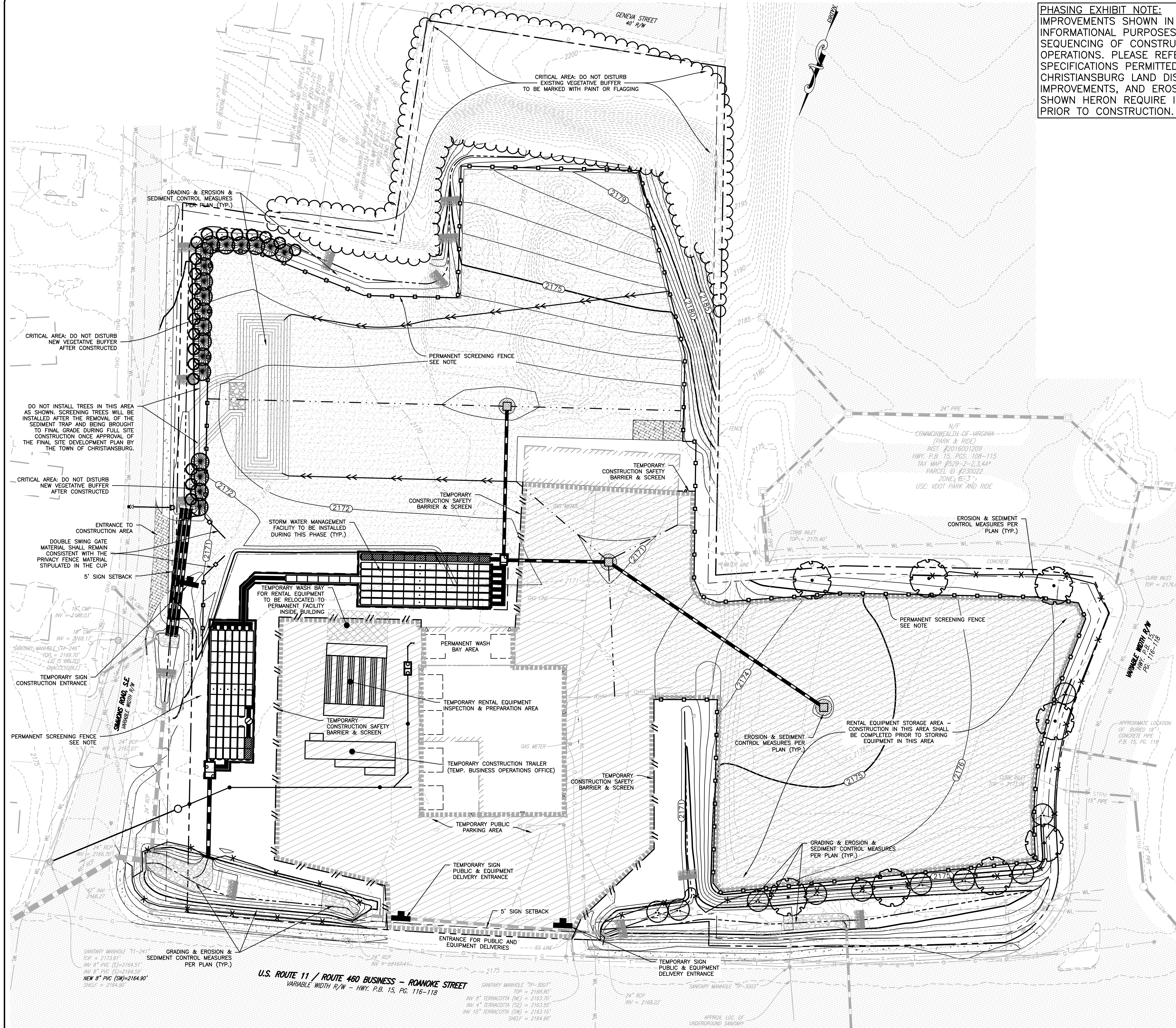

LEGEND

AREA OF TEMPORARY
BUSINESS OPERATIONS

NOTE

1. PERMANENT SCREENING FENCE & LANDSCAPING TO BE INSTALLED IN ACCORDANCE WITH THE CUP CONDITIONS. INSTALL EXTENTS OF PERMANENT SCREENING FENCE AND LANDSCAPING ALONG WITH GRADING AS NECESSARY FOR INSTALLATION PRIOR TO PROGRESSING TO THE REMAINDER OF CONSTRUCTION OPERATIONS AS SHOWN ON THIS SHEET. REFER TO THE CONDITIONAL USE PERMIT APPLICATION FOR SPECIFICATIONS.

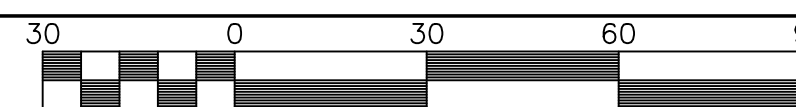
$$1'' = 30$$

Michael Kelley

09/11/2024
7:46:17 AM

APPROVED: Engineering

Date _____

Retta Jackson

09/11/2024
7:47:54 AM

APPROVED: Planning

Date _____

11/20/2024 24/24230101 00 CASTER MACHINE BY CHRISTIAN SBIJDSMA 1440-TEMPORARY SITE OF AN OLD BOTTLED 8/14/2024 4:30-01 PM