

LEGEND

C-SCM-01	DUST CONTROL	DC	C-SSM-09	TEMPORARY SEEDING	TS
C-SCM-03	TEMPORARY STONE CONSTRUCTION ENTRANCE	CE	C-SSM-10	PERMANENT SEEDING	PS
C-SCM-04	INLET PROTECTION	IP	C-SSM-11	MULCHING	MU
C-SSM-02	TOPSOILING	TO	C-PCM-04	SILT FENCE	SF

TS MU DC APPLY TO ALL DENUDED AREAS
PS TO MU APPLY TO ALL DENUDED AREAS THAT HAVE REACHED FINAL GRADE

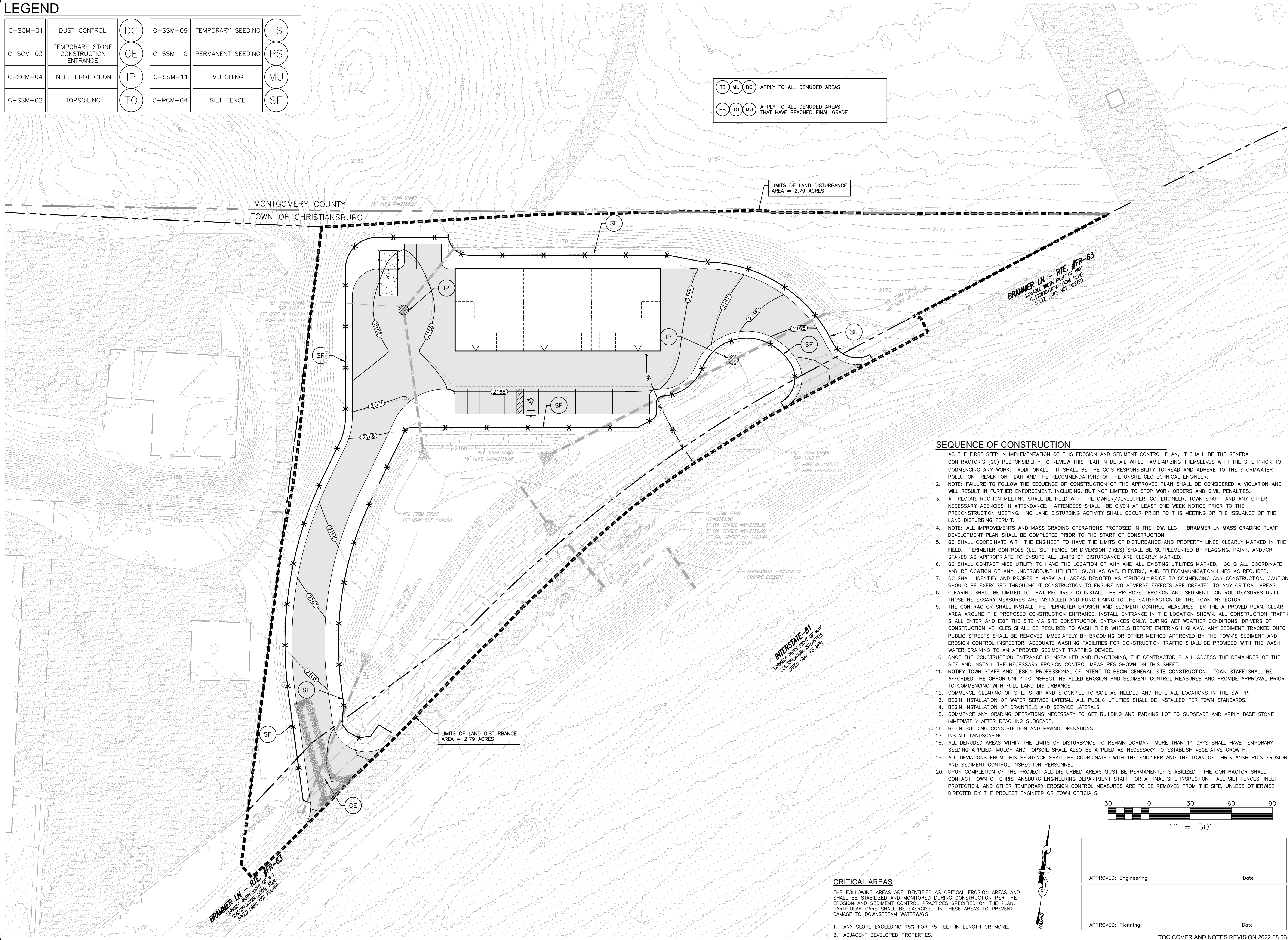

SEQUENCE OF CONSTRUCTION

- AS THE FIRST STEP IN IMPLEMENTATION OF THIS EROSION AND SEDIMENT CONTROL PLAN, IT SHALL BE THE GENERAL CONTRACTOR'S (GC) RESPONSIBILITY TO REVIEW THIS PLAN IN DETAIL WHILE FAMILIARIZING THEMSELVES WITH THE SITE PRIOR TO COMMENCING ANY WORK. ADDITIONALLY, IT SHALL BE THE GC'S RESPONSIBILITY TO READ AND ADHERE TO THE STORMWATER POLLUTION PREVENTION PLAN AND THE RECOMMENDATIONS OF THE ONSITE GEOTECHNICAL ENGINEER.
- NOTE: FAILURE TO FOLLOW THE SEQUENCE OF CONSTRUCTION OF THE APPROVED PLAN SHALL BE CONSIDERED A VIOLATION AND WILL RESULT IN FURTHER ENFORCEMENT, INCLUDING, BUT NOT LIMITED TO STOP WORK ORDERS AND CIVIL PENALTIES.
- A PRECONSTRUCTION MEETING SHALL BE HELD WITH THE OWNER/DEVELOPER, GC, ENGINEER, TOWN STAFF, AND ANY OTHER NECESSARY AGENCIES IN ATTENDANCE. ATTENDEES SHALL BE GIVEN AT LEAST ONE WEEK NOTICE PRIOR TO THE PRECONSTRUCTION MEETING. NO LAND DISTURBING ACTIVITY SHALL OCCUR PRIOR TO THIS MEETING OR THE ISSUANCE OF THE LAND DISTURBING PERMIT.
- NOTE: ALL IMPROVEMENTS AND MASS GRADING OPERATIONS PROPOSED IN THE "DW, LLC - BRAMMER LN MASS GRADING PLAN" DEVELOPMENT PLAN SHALL BE COMPLETED PRIOR TO THE START OF CONSTRUCTION.
- GC SHALL COORDINATE WITH THE ENGINEER TO HAVE THE LIMITS OF DISTURBANCE AND PROPERTY LINES CLEARLY MARKED IN THE FIELD. PERIMETER CONTROLS (I.E. SILT FENCE OR DIVERSION DIKES) SHALL BE SUPPLEMENTED BY FLAGGING, PAINT, AND/OR STAKES AS APPROPRIATE TO ENSURE ALL LIMITS OF DISTURBANCE ARE CLEARLY MARKED.
- GC SHALL CONTACT MISS UTILITY TO HAVE THE LOCATION OF ANY AND ALL EXISTING UTILITIES MARKED. GC SHALL COORDINATE ANY RELOCATION OF ANY UNDERGROUND UTILITIES, SUCH AS GAS, ELECTRIC, AND TELECOMMUNICATION LINES AS REQUIRED.
- GC SHALL IDENTIFY AND PROPERLY MARK ALL AREAS DENOTED AS "CRITICAL" PRIOR TO COMMENCING ANY CONSTRUCTION. CAUTION SHOULD BE EXERCISED THROUGHOUT CONSTRUCTION TO ENSURE NO ADVERSE EFFECTS ARE CREATED TO ANY CRITICAL AREAS.
- CLEARING SHALL BE LIMITED TO THAT REQUIRED TO INSTALL THE PROPOSED EROSION AND SEDIMENT CONTROL MEASURES UNTIL THOSE NECESSARY MEASURES ARE INSTALLED AND FUNCTIONING TO THE SATISFACTION OF THE TOWN INSPECTOR.
- THE CONTRACTOR SHALL INSTALL THE PERIMETER EROSION AND SEDIMENT CONTROL MEASURES PER THE APPROVED PLAN. CLEAR AREA AROUND THE PROPOSED CONSTRUCTION ENTRANCE, INSTALL ENTRANCE IN THE LOCATION SHOWN. ALL CONSTRUCTION TRAFFIC SHALL ENTER AND EXIT THE SITE VIA SITE CONSTRUCTION ENTRANCES ONLY. DURING WET WEATHER CONDITIONS, DRIVERS OF CONSTRUCTION VEHICLES SHALL BE REQUIRED TO WASH THEIR WHEELS BEFORE ENTERING HIGHWAY. ANY SEDIMENT TRACKED ONTO PUBLIC STREETS SHALL BE REMOVED IMMEDIATELY BY BROOMING OR OTHER METHOD APPROVED BY THE TOWN'S SEDIMENT AND EROSION CONTROL INSPECTOR. ADEQUATE WASHING FACILITIES FOR CONSTRUCTION TRAFFIC SHALL BE PROVIDED WITH THE WASH WATER DRAINING TO AN APPROVED SEDIMENT TRAPPING DEVICE.
- ONCE THE CONSTRUCTION ENTRANCE IS INSTALLED AND FUNCTIONING, THE CONTRACTOR SHALL ACCESS THE REMAINDER OF THE SITE AND INSTALL THE NECESSARY EROSION CONTROL MEASURES SHOWN ON THIS SHEET.
- NOTIFY TOWN STAFF AND DESIGN PROFESSIONAL OF INTENT TO BEGIN GENERAL SITE CONSTRUCTION. TOWN STAFF SHALL BE AFFORDED THE OPPORTUNITY TO INSPECT INSTALLED EROSION AND SEDIMENT CONTROL MEASURES AND PROVIDE APPROVAL PRIOR TO COMMENCING WITH FULL LAND DISTURBANCE.
- COMMENCE CLEARING OF SITE, STRIP AND STOCKPILE TOPSOIL AS NEEDED AND NOTE ALL LOCATIONS IN THE SWPPP.
- BEGIN INSTALLATION OF WATER SERVICE LATERAL. ALL PUBLIC UTILITIES SHALL BE INSTALLED PER TOWN STANDARDS.
- BEGIN INSTALLATION OF DRAINFIELD AND SERVICE LATERALS.
- COMMENCE ANY GRADING OPERATIONS NECESSARY TO GET BUILDING AND PARKING LOT TO SUBGRADE AND APPLY BASE STONE IMMEDIATELY AFTER REACHING SUBGRADE.
- BEGIN BUILDING CONSTRUCTION AND PAVING OPERATIONS.
- INSTALL LANDSCAPING.
- ALL DENUDED AREAS WITHIN THE LIMITS OF DISTURBANCE TO REMAIN DORMANT MORE THAN 14 DAYS SHALL HAVE TEMPORARY SEEDING APPLIED. MULCH AND TOPSOIL SHALL ALSO BE APPLIED AS NECESSARY TO ESTABLISH VEGETATIVE GROWTH.
- ALL DEVIATIONS FROM THIS SEQUENCE SHALL BE COORDINATED WITH THE ENGINEER AND THE TOWN OF CHRISTIANSBURG'S EROSION AND SEDIMENT CONTROL INSPECTION PERSONNEL.
- UPON COMPLETION OF THE PROJECT ALL DISTURBED AREAS MUST BE PERMANENTLY STABILIZED. THE CONTRACTOR SHALL CONTACT TOWN OF CHRISTIANSBURG ENGINEERING DEPARTMENT STAFF FOR A FINAL SITE INSPECTION. ALL SILT FENCES, INLET PROTECTION, AND OTHER TEMPORARY EROSION CONTROL MEASURES ARE TO BE REMOVED FROM THE SITE, UNLESS OTHERWISE DIRECTED BY THE PROJECT ENGINEER OR TOWN OFFICIALS.

CRITICAL AREAS

THE FOLLOWING AREAS ARE IDENTIFIED AS CRITICAL EROSION AREAS AND SHALL BE STABILIZED AND MONITORED DURING CONSTRUCTION PER THE EROSION AND SEDIMENT CONTROL PRACTICES SPECIFIED ON THE PLAN. PARTICULAR CARE SHALL BE EXERCISED IN THESE AREAS TO PREVENT DAMAGE TO DOWNSTREAM WATERWAYS:

- ANY SLOPE EXCEEDING 15% FOR 75 FEET IN LENGTH OR MORE.
- ADJACENT DEVELOPED PROPERTIES.

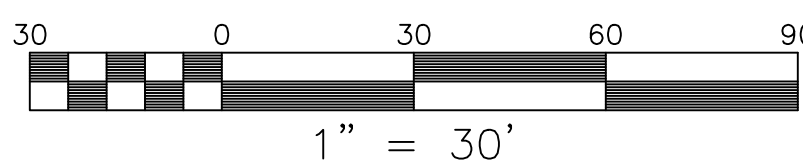

APPROVED: Engineering	Date
APPROVED: Planning	Date

TOC COVER AND NOTES REVISION 2022.08.03

DW, LLC - BRAMMER LN SITE PLAN

EROSION & SEDIMENT CONTROL PLAN

SHAWSVILLE MAGISTERIAL DISTRICT
260 BRAMMER LN, CHRISTIANSBURG, VIRGINIA

DRAWN BY ACN
DESIGNED BY ACN
CHECKED BY ACN
DATE 10/15/2025
SCALE 1" = 30'
REVISIONS

BALZER & ASSOCIATES
a Westwood Company
Roanoke / Richmond
New River Valley
Shenandoah Valley
balzer.cc | westwoodps.com
80 College Street
Suite H
Christiansburg, VA 24073
540.381.4290

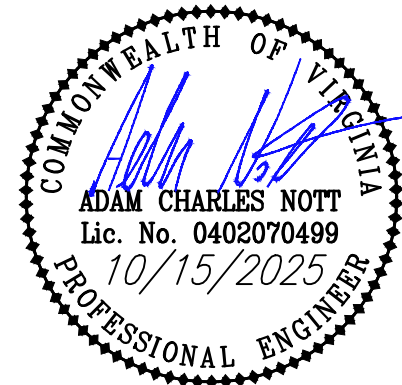

C5
PROJECT NO. 24230065.00