

X:\Drawings\3859\ENGINEERING\Design\Plans\3859_Sht_C2_Site_Layout_Plan - Conston Ave.dwg
SITE LAYOUT AND GRADING PLAN, 12/01/2025 4:48:13 PM, Hlowery, AutoCAD PDF (General Documentation).pc3, 1:1

BUS STOP #2227 DEMOLITION PLAN

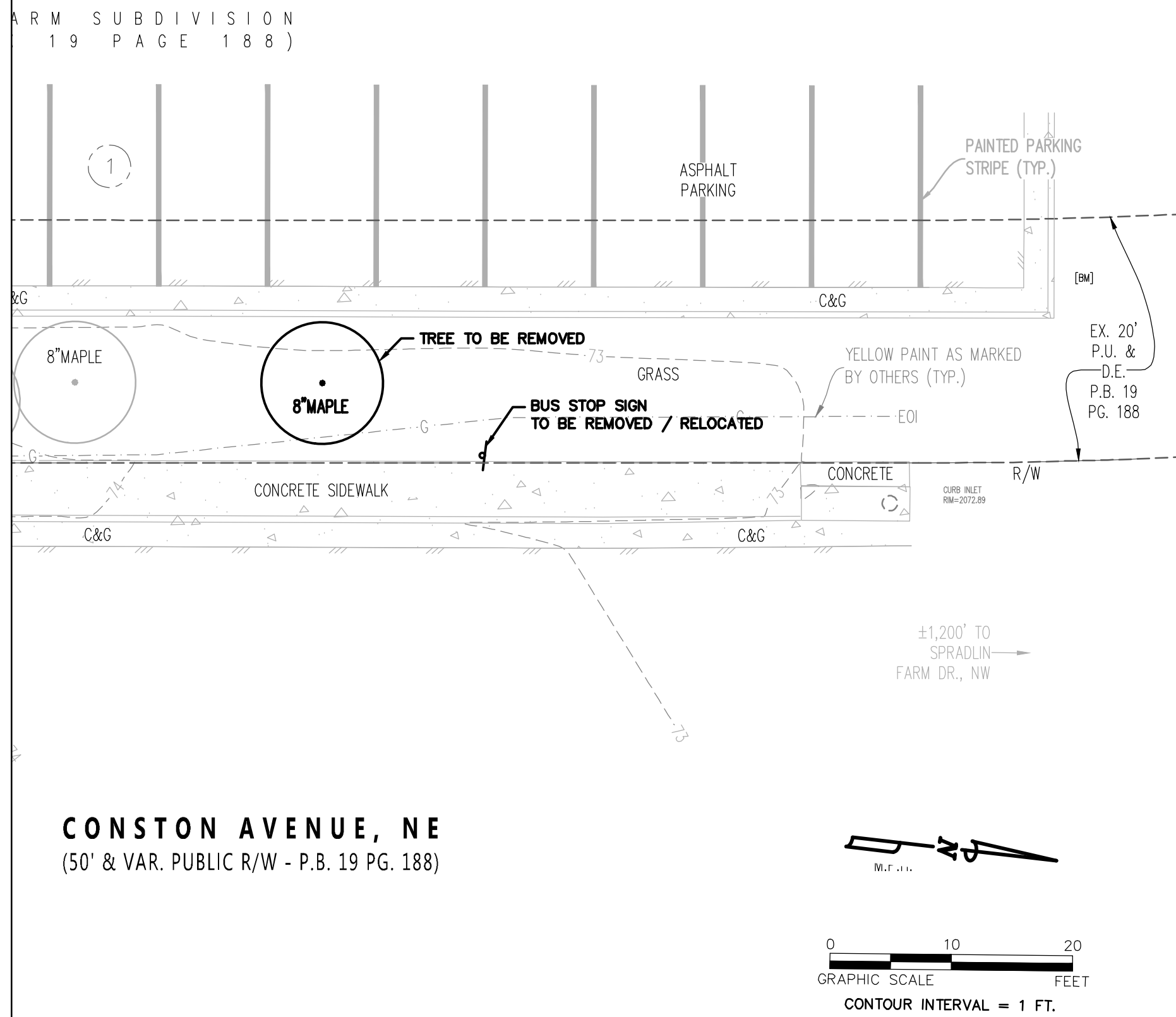

BUS STOP #2227 SITE LAYOUT PLAN

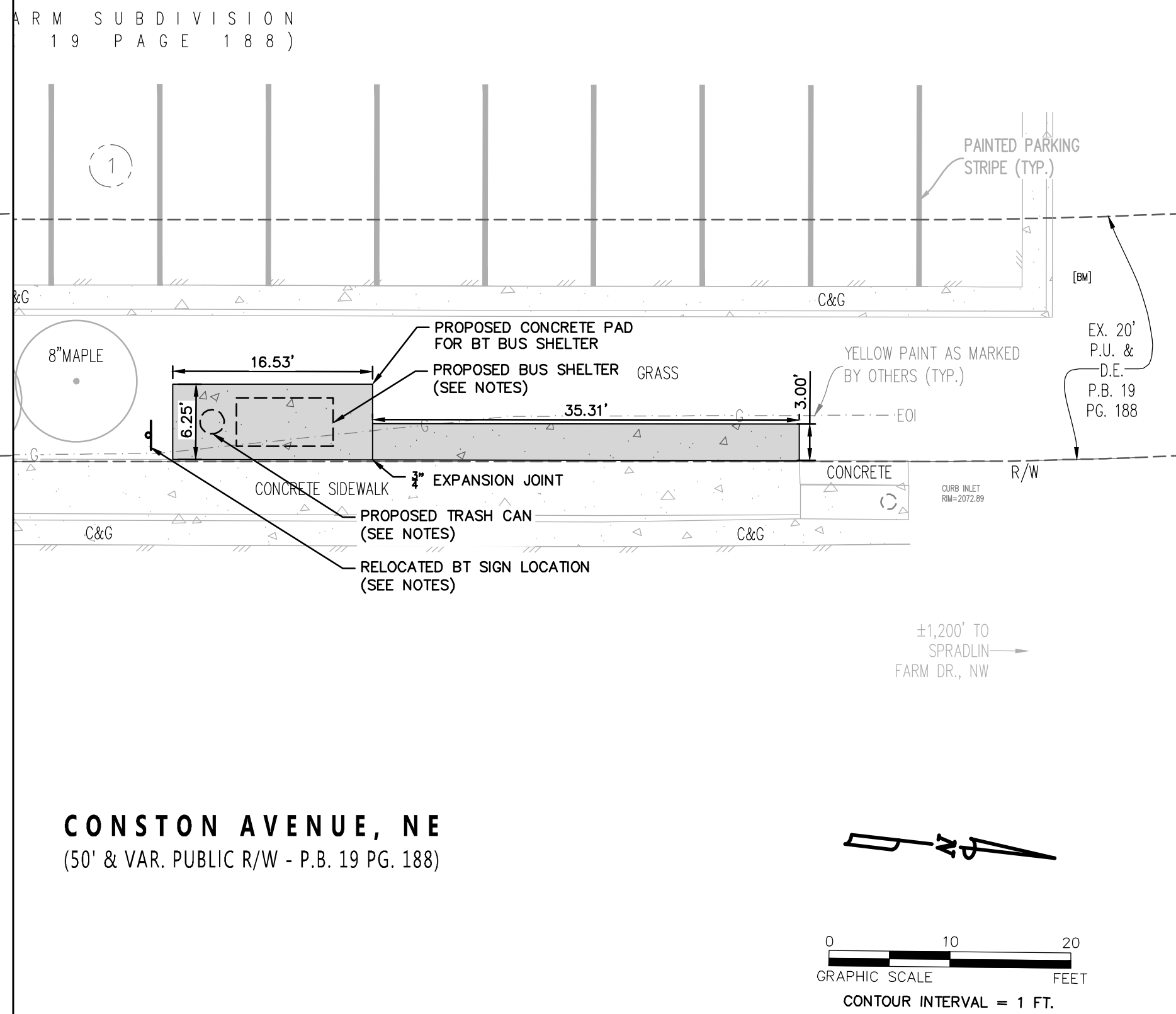

INSTALLATION NOTES:

- CONTRACTOR SHALL INSTALL CONCRETE PAD AND BUS SHELTER AS SHOWN. THE BUS SHELTER WILL BE PROVIDED TO THE CONTRACTOR BY BLACKSBURG TRANSIT FOR INSTALLATION. THE CONTRACTOR SHALL PROVIDE ALL OTHER MATERIALS. CONTRACTOR SHALL CONFORM TO THE TOLAR MANUFACTURING COMPANY INSTALLATION STANDARDS FOR A 4'x8' NON AD BUS STOP SHELTER "NIAGARA SERIES" WITH REAR AND SIDE GLASS PANELS.
- CONTRACTOR SHALL INSTALL SOLAR PANELS ATOP THE BUS SHELTER TO POWER BT BUS SHELTER LIGHTING. INSTALLATION OF SOLAR PANELS SHALL CONFORM WITH ALL APPLICABLE CODES.
- BUS SHELTER STRUCTURE SHOWN HEREON FOR INFORMATION PURPOSES ONLY. CONTRACTOR SHALL VERIFY DIMENSIONS FOR CORNER POSTS WITH SHELTER MANUFACTURER.
- RELOCATED BT SIGN POST SHALL BE INSTALLED 2' FROM THE EDGE OF PAVEMENT AS SHOWN ON THE SITE LAYOUT.
- PROPOSED TRASH CAN SHALL BE INSTALLED A MINIMUM DISTANCE OF 2' FROM THE PROPOSED SHELTER GLASS.

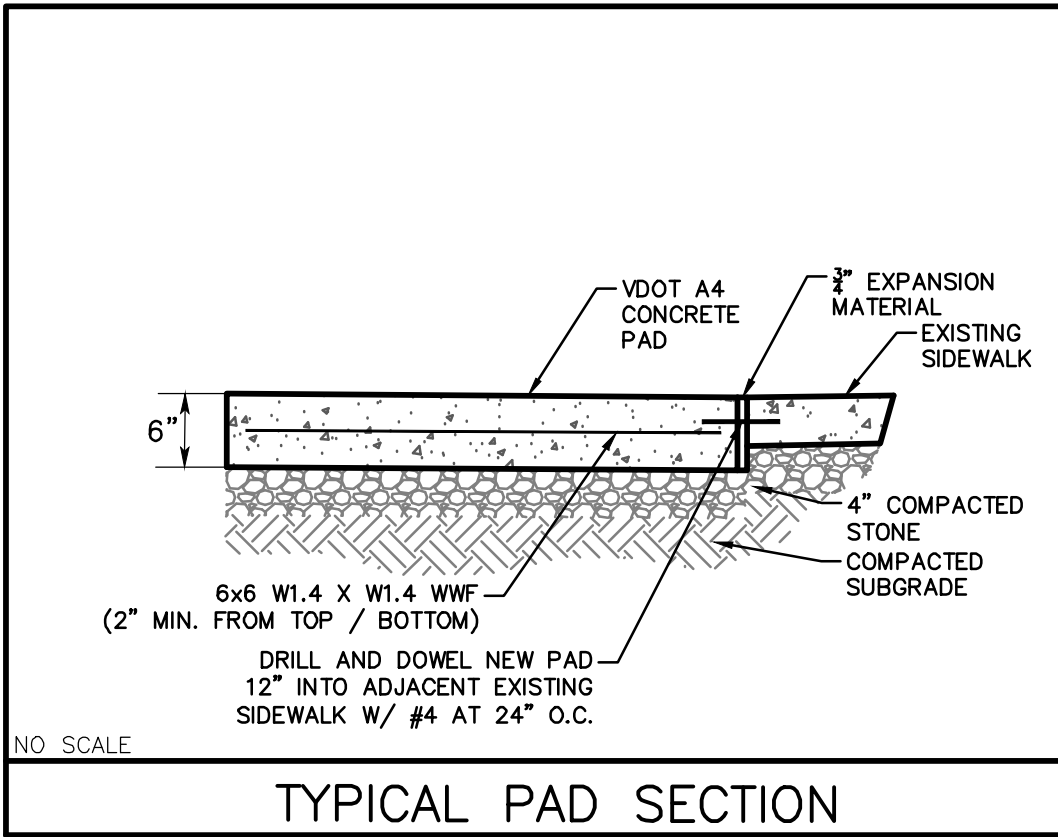

BUS STOP #2227 GRADING PLAN

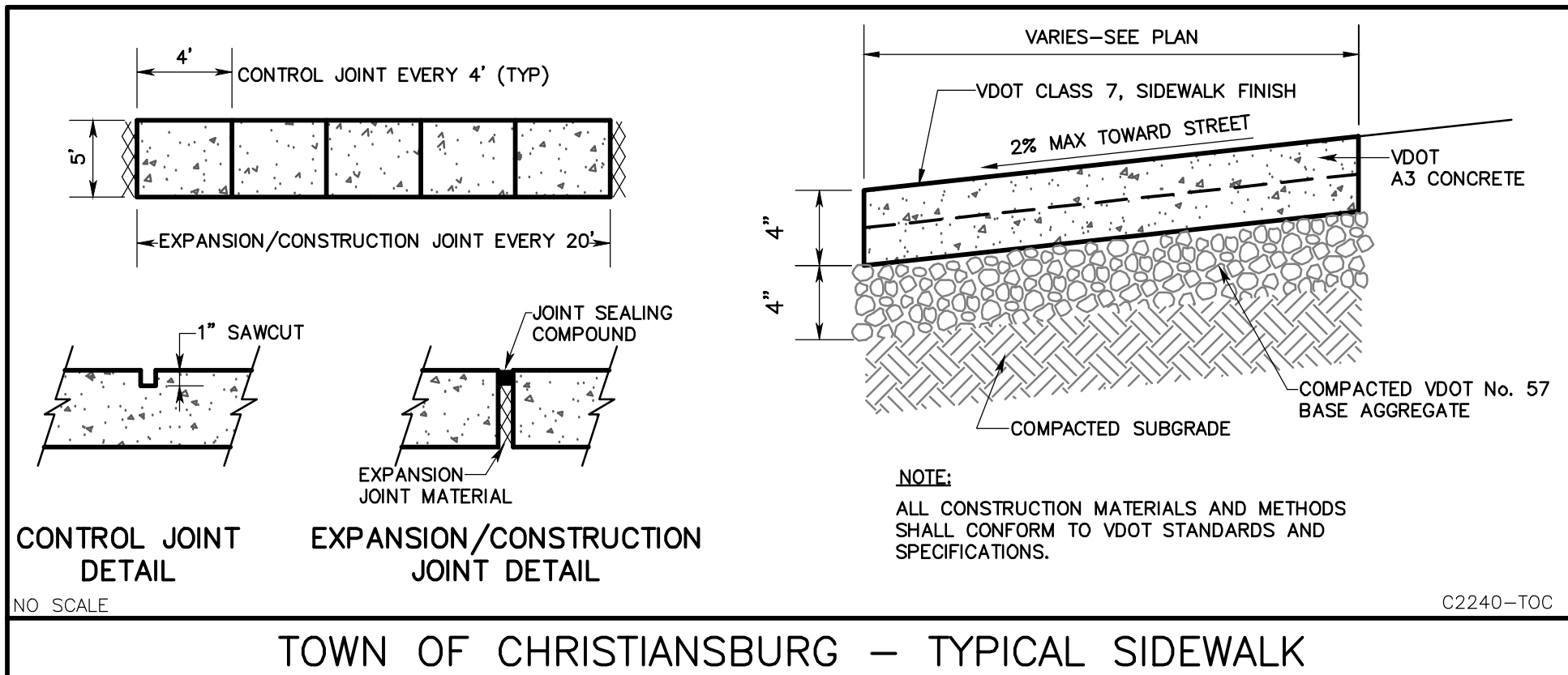
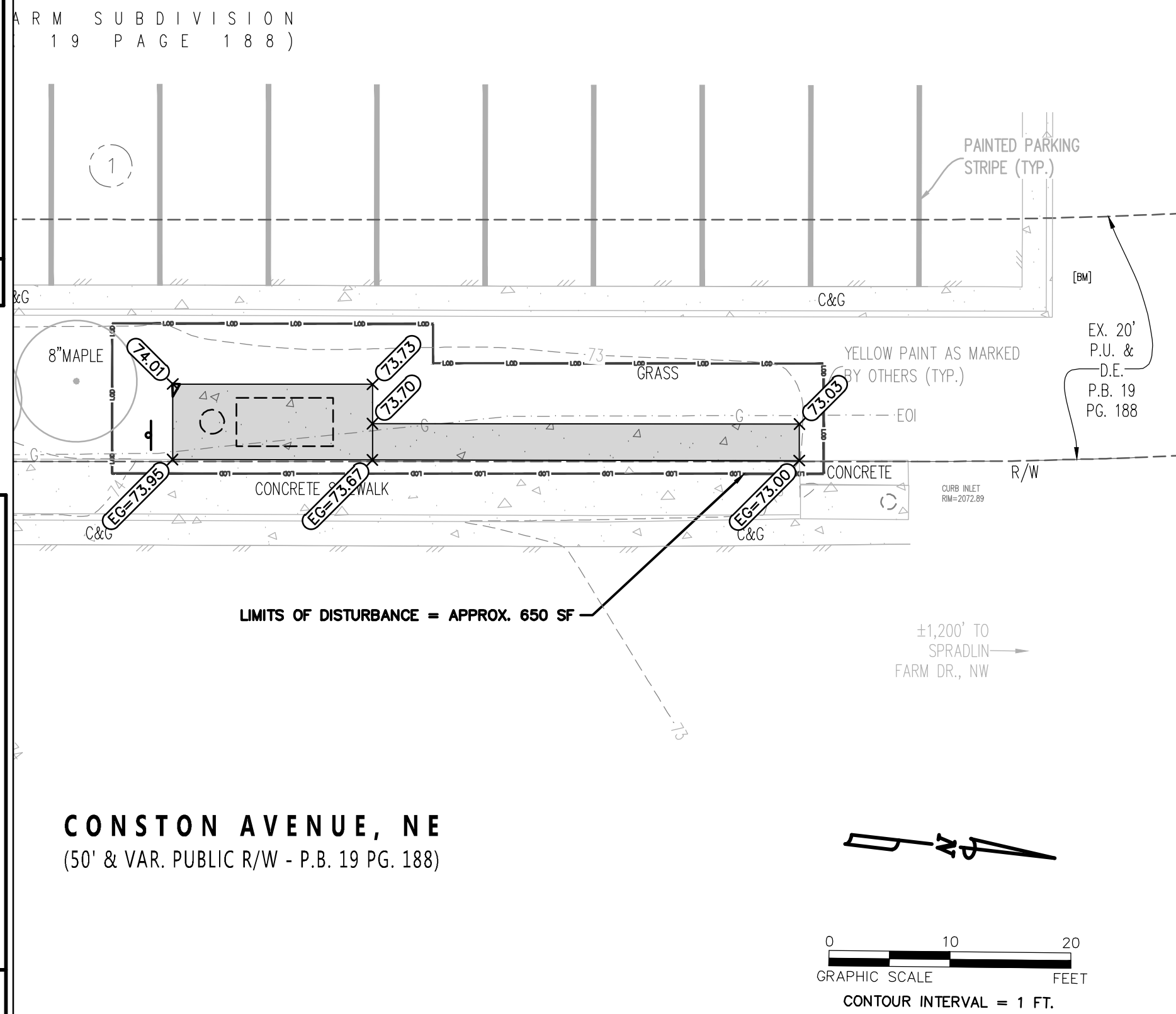

APPROVED: Engineering Date

APPROVED: Planning Date

The drawing, design, and digital files relating to this project are the property of Foresight Design Services. The reproduction, copying, or other use of this drawing without FDS's written consent is prohibited.

BT CHRISTIANBURG
BUS STOP DESIGN #2227

TOWN OF CHRISTIANBURG, VIRGINIA

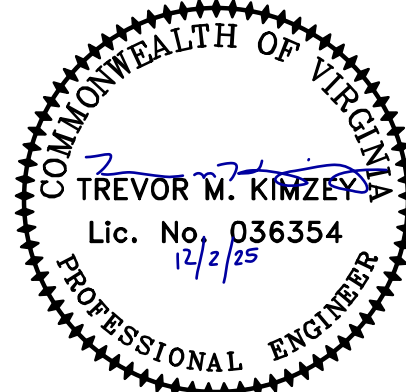

REVISIONS

NO.	COMMENTS	DATE

PROJECT TEAM

PIC	TREVOR M. KIMZEY, PE
PM	TREVOR M. KIMZEY, PE
DESIGN	HMH

ISSUE DATE

12/02/2025

FDS JOB NO.

3859

SHEET TITLE

DEMOLITION, SITE LAYOUT,
AND GRADING PLAN

SHEET NUMBER

C2-01