

REVISIONS			
NO.	BY	DESCRIPTION	DATE
3	JBS	TOWN REVIEW COMMENTS	7/6
2	JBS	TOWN REVIEW COMMENTS	6/2
1	JBS	REVISE BLDG. LOCATION	4/25

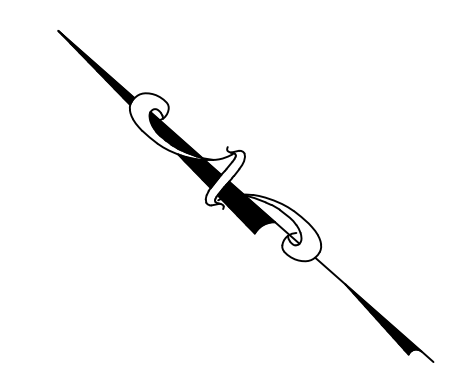

LEGEND	
	PROPOSED 24" CONCRETE CURB & GUTTER
	EXISTING CONCRETE CURB & GUTTER
	PROPOSED SITE LIGHTING POLE

SITE & BUILDING DATA:

TOTAL PARCEL AREA = 2.23 ACRES
TOTAL IMPERVIOUS AREA = 1.61 ACRES
PERCENT IMPERVIOUS = 72.0%
GREENSPACE: REQUIRED = (20%) = 19,428 S.F.
PROVIDED = 27,207 S.F.
INTERIOR GREENSPACE: REQUIRED = (77 SPACES X 40) = 3,080 S.F.
PROVIDED = 3,399 S.F.
TREES: GREENSPACE REQUIRED = 49, PROVIDED = 45 + 4 EXISTING
PARKING LOT REQUIRED = 8, PROVIDED = 11
SITE ZONING: "B-3", GENERAL BUSINESS DISTRICT
BUILDING AREA = 19,054 S.F.
HEIGHT OF ALDI BUILDING: 20'-1 1/2" TOP OF WALL STUD
27'-8 3/4" TOP OF ENTRY FEATURE
BUILDING IS ONE STORY.
PER TOWN OF CHRISTIANSBURG ZONING REQUIREMENTS:
PARKING REQUIRED = (1 SPACE PER 250 S.F. OF FLOOR AREA FOR THE FIRST 5,000 S.F.) + (1 SPACE PER 300 S.F. OF FLOOR AREA FOR THE SECOND 5,000 S.F.) + (1 SPACE PER 350 S.F. FLOOR AREA FOR THE THIRD 5,000 S.F. AND ALL SUBSEQUENT SQUARE FOOTAGE) = 63 SPACES
PARKING PROVIDED = 77 SPACES INCLUDING 4 HANDICAP SPACES
LOADING SPACES REQUIRED AND PROVIDED = 1 @ LOADING DOCK
Parking space striping lines shall be 4" wide with measurements always to the stripes centerline (yellow in color).
Type of building construction : one (1) commercial building
Proposed Use: Retail (Grocery Store)

APPROVAL BLOCK	
PLANNING:	DATE
ENGINEERING:	DATE

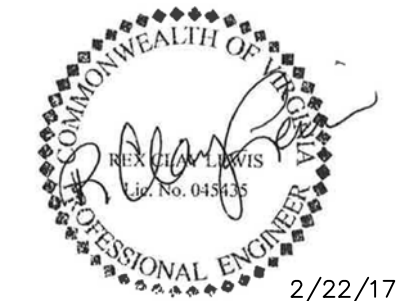
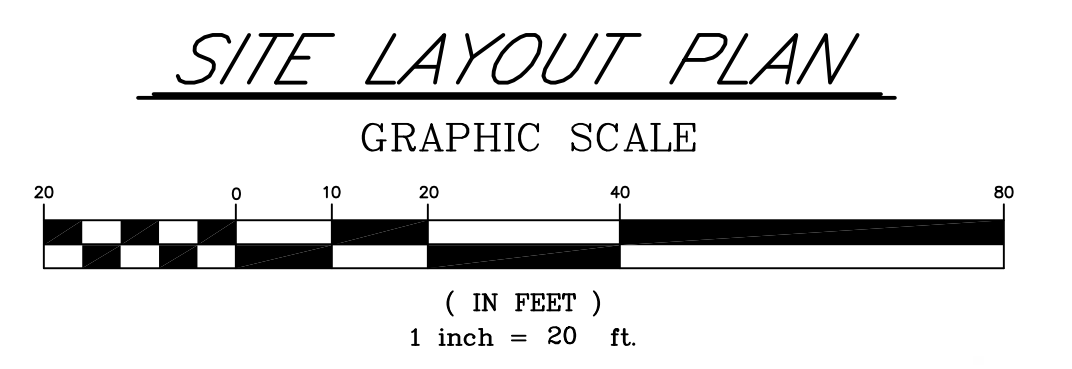

2/22/17
HGA JOB NO. 2017-034

HAINES, GIPSON & ASSOCIATES, INC.
CONSULTING ENGINEERS
1550 NORTH BROWN RD., SUITE 100
LAWRENCEVILLE, GEORGIA 30043
PHONE: (770) 491-7550 FAX: (770) 491-7750

ALDI, Inc.
1985 Union Church Road
Salisbury, NC 28146
(704) 642-0223 tel
(704) 642-0078 fax
Christiansburg, Virginia

Drn. JBS Des. JBS Chk. RCL Date 2/22/17 Sheet C-6

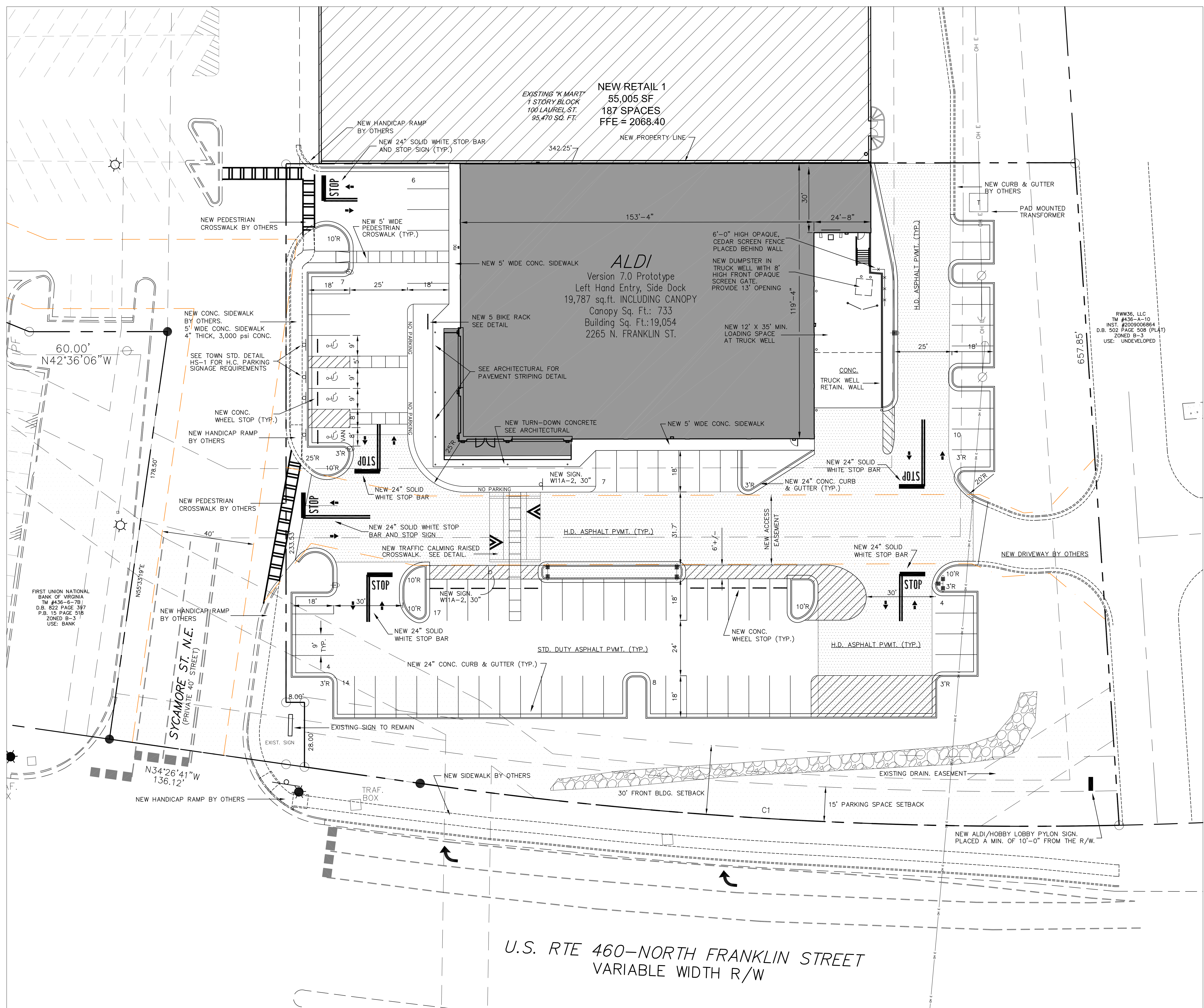

U.S. RTE 460-NORTH FRANKLIN STREET
VARIABLE WIDTH R/W