

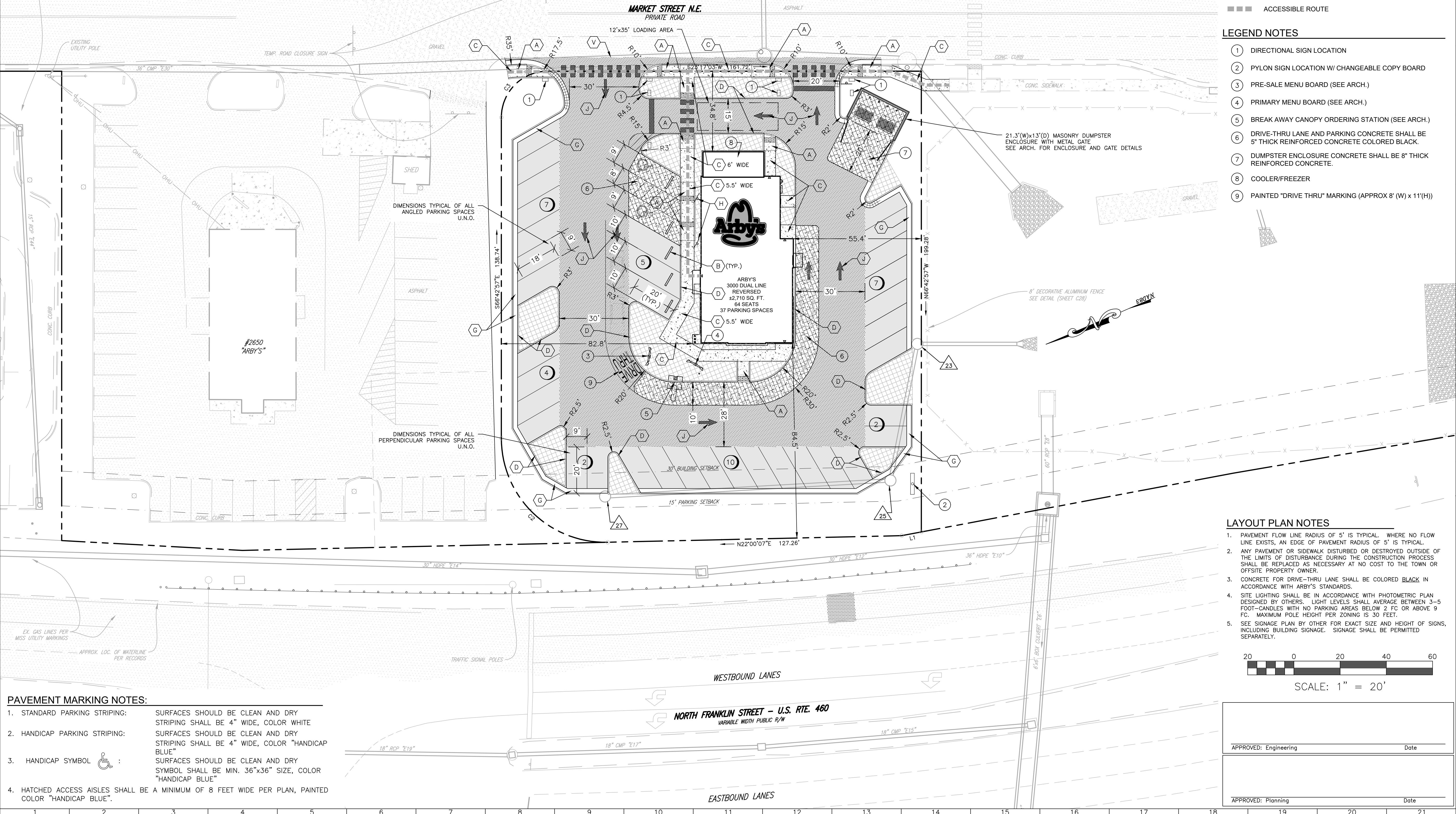

| CURVE TABLE | | | | | |
|-------------|--------|--------|-----------|---------------|--------------|
| CURVE # | LENGTH | RADIUS | DELTA | CHORD BEARING | CHORD LENGTH |
| C2 | 71.69' | 45.00' | 91°17'02" | N67°38'32"E | 64.35' |
| C3 | 31.42' | 20.00' | 90°00'00" | S21°42'57"E | 28.28' |

| LINE TABLE | | |
|------------|--------|-------------|
| LINE # | LENGTH | BEARING |
| L1 | 8.63' | N12°36'57"E |

N/F
FU-HUA CHEN, ET AL
INST. #2004015317
P.G. 15, PG. 210 - "OUT PARCEL B"
TAX MAP #436-5-B
PARCEL ID #029851
USE: RESTAURANT



| PAVEMENT MARKING NOTES: | |
|--|---|
| 1. STANDARD PARKING STRIPING: | SURFACES SHOULD BE CLEAN AND DRY STRIPING SHALL BE 4" WIDE, COLOR WHITE |
| 2. HANDICAP PARKING STRIPING: | SURFACES SHOULD BE CLEAN AND DRY STRIPING SHALL BE 4" WIDE, COLOR "HANDICAP BLUE" |
| 3. HANDICAP SYMBOL  : | SURFACES SHOULD BE CLEAN AND DRY SYMBOL SHALL BE MIN. 36"x36" SIZE, COLOR "HANDICAP BLUE" |
| 4. HATCHED ACCESS AISLES SHALL BE A MINIMUM OF 8 FEET WIDE PER PLAN, PAINTED COLOR "HANDICAP BLUE". | |

LEGEND

A

CG-12 CURB RAMP

B

PARKING BUMPER BLOCK

C

CONCRETE SIDEWALK
5' WIDE U.N.O.

D

CG-2 CURB

G

CG-6 CURB AND GUTTER

H

HANDICAP PARKING & SIGN

J

DIRECTIONAL ARROW

K

CROSSWALK MARKING

N

24" WIDE STOP BAR MARKING

O

VDOT R1-1 STOP SIGN

V

PAVEMENT JOINT

STANDARD DUTY ASPHALT PAVING

HEAVY DUTY ASPHALT PAVING

CONCRETE SIDEWALK

HEAVY DUTY CONCRETE PAVING
THICKNESS AS NOTED

ACCESSIBLE ROUTE

LEGEND NOTES

1

DIRECTIONAL SIGN LOCATION

2

PYLON SIGN LOCATION W/ CHANGEABLE COPY BOARD

3

PRE-SALE MENU BOARD (SEE ARCH.)

4

PRIMARY MENU BOARD (SEE ARCH.)

5

BREAK AWAY CANOPY ORDERING STATION (SEE ARCH.)

6

DRIVE-THRU LANE AND PARKING CONCRETE SHALL BE 5" THICK REINFORCED CONCRETE COLORED BLACK.

7

DUMPSTER ENCLOSURE CONCRETE SHALL BE 8" THICK REINFORCED CONCRETE.

8

COOLER/FREEZER

9

PAINTED "DRIVE THRU" MARKING (APPROX 8' (W) x 11'(H))

200

0

20

40

60

SCALE: 1" = 20'

APPROVED: Engineering

Date

APPROVED: Planning

Date



REFLECTING TOMORROW
www.balzer.cc
New River Valley
Roanoke
Richmond
Staunton
Harrisonburg
Lynchburg

RESIDENTIAL LAND DEVELOPMENT ENGINEERING
SITE DEVELOPMENT ENGINEERING
LAND USE PLANNING & ZONING
LANDSCAPE ARCHITECTURE
LAND SURVEYING
ARCHITECTURE
STRUCTURAL ENGINEERING
TRANSPORTATION ENGINEERING
ENVIRONMENTAL & SOIL SCIENCE
WETLAND DELINEATIONS & STREAM EVALUATIONS

Balzer and Associates, Inc.
448 Peppers Ferry Road, NW
Christiansburg, VA 24073
540-381-4290
FAX 540-381-4291

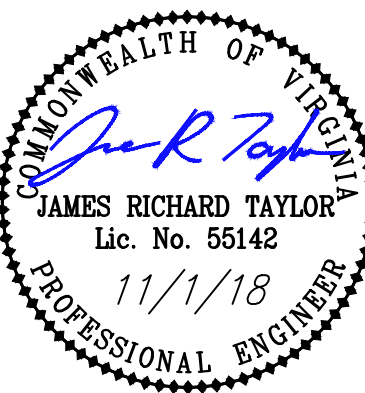

ARBY'S #8156
2650 MARKET STREET N.E.
LAYOUT AND DIMENSIONAL PLAN
SHAWSVILLE MAGISTERIAL DISTRICT
TOWN OF CHRISTIANBURG, VIRGINIA

DRAWN BY JRT
DESIGNED BY JRT
CHECKED BY SMS
DATE 11/1/18
SCALE 1" = 20'
REVISIONS:

SHEET NO.
C4
JOB NO. 24180098.00