

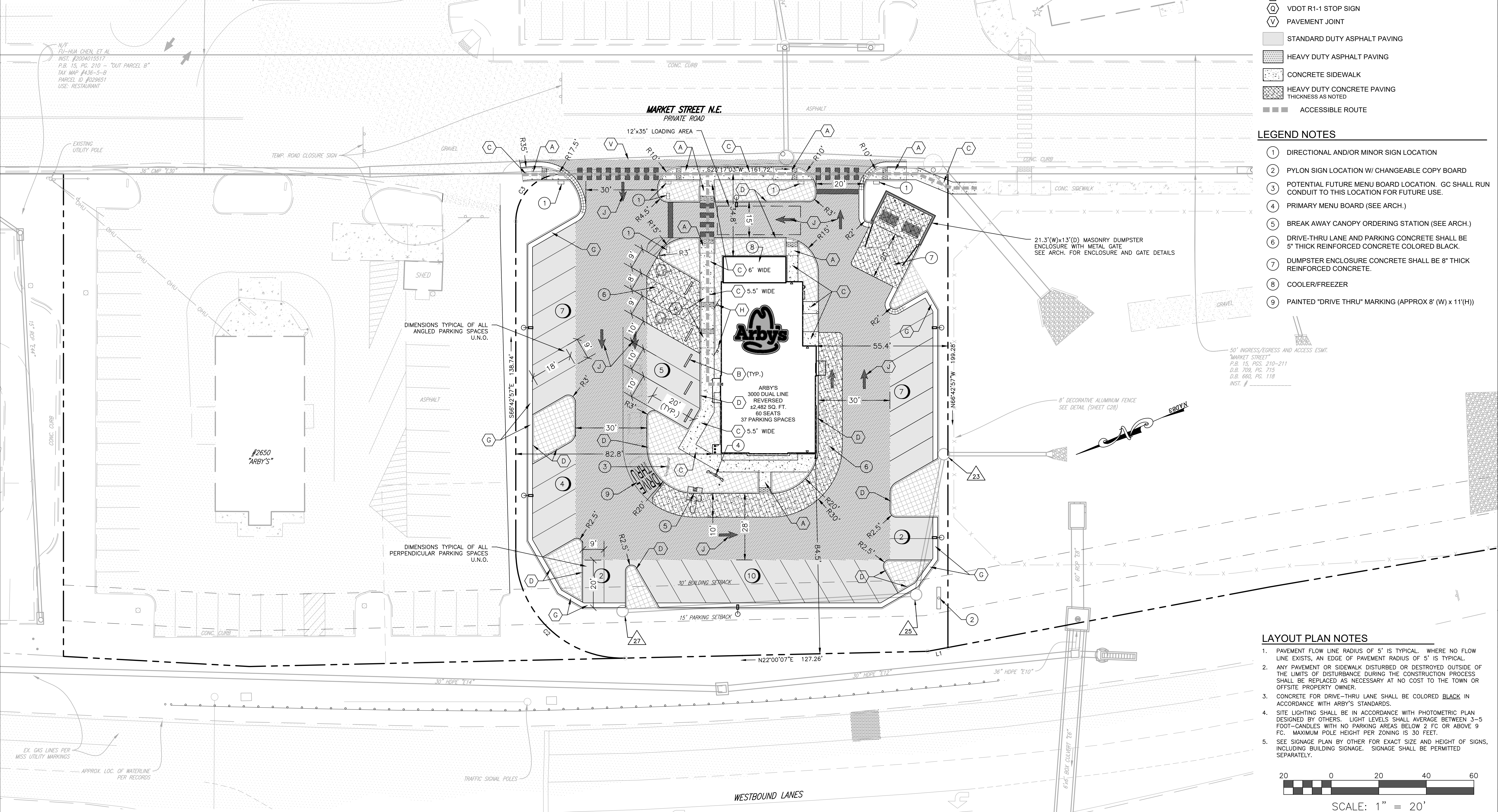

CURVE TABLE					
CURVE #	LENGTH	RADIUS	DELTA	CHORD BEARING	CHORD LENGTH
C2	71.69'	45.00'	91°17'02"	N67°38'32"E	64.35'
C3	31.42'	20.00'	90°00'00"	S21°42'57"E	28.28'

LINE TABLE		
LINE #	LENGTH	BEARING
L1	8.63'	N12°36'57"E



PAVEMENT MARKING NOTES:		
1. STANDARD PARKING STRIPING:	SURFACES SHOULD BE CLEAN AND DRY STRIPING SHALL BE 4" WIDE, COLOR WHITE	
2. HANDICAP PARKING STRIPING:	SURFACES SHOULD BE CLEAN AND DRY STRIPING SHALL BE 4" WIDE, COLOR "HANDICAP BLUE"	
3. HANDICAP SYMBOL  :	SURFACES SHOULD BE CLEAN AND DRY SYMBOL SHALL BE MIN. 36"x36" SIZE, COLOR "HANDICAP BLUE"	
4. HATCHED ACCESS AISLES SHALL BE A MINIMUM OF 8 FEET WIDE PER PLAN, PAINTED COLOR "HANDICAP BLUE".		

LEGEND

A

B

C

D

G

H

J

K

N

O

V

CG-12 CURB RAMP

PARKING BUMPER BLOCK

CONCRETE SIDEWALK
5' WIDE U.N.O.

CG-2 CURB

CG-6 CURB AND GUTTER

HANDICAP PARKING & SIGN

DIRECTIONAL ARROW

CROSSWALK MARKING

24" WIDE STOP BAR MARKING

VDOT R1-1 STOP SIGN

PAVEMENT JOINT

STANDARD DUTY ASPHALT PAVING

HEAVY DUTY ASPHALT PAVING

CONCRETE SIDEWALK

HEAVY DUTY CONCRETE PAVING
THICKNESS AS NOTED

ACCESSIBLE ROUTE

- LEGEND NOTES
- 1

2

3

4

5

6

7

8

9
- DIRECTIONAL AND/OR MINOR SIGN LOCATION

PYLON SIGN LOCATION W/ CHANGEABLE COPY BOARD

POTENTIAL FUTURE MENU BOARD LOCATION. GC SHALL RUN CONDUIT TO THIS LOCATION FOR FUTURE USE.

PRIMARY MENU BOARD (SEE ARCH.)

BREAK AWAY CANOPY ORDERING STATION (SEE ARCH.)

DRIVE-THRU LANE AND PARKING CONCRETE SHALL BE 5" THICK REINFORCED CONCRETE COLORED BLACK.

DUMPSTER ENCLOSURE CONCRETE SHALL BE 8" THICK REINFORCED CONCRETE.

COOLER/FREEZER

PAINTED "DRIVE THRU" MARKING (APPROX 8' (W) x 11'(H))

- LAYOUT PLAN NOTES
1.

2.

3.

4.

5.
- PAVEMENT FLOW LINE RADIUS OF 5' IS TYPICAL. WHERE NO FLOW LINE EXISTS, AN EDGE OF PAVEMENT RADIUS OF 5' IS TYPICAL.

ANY PAVEMENT OR SIDEWALK DISTURBED OR DESTROYED OUTSIDE OF THE LIMITS OF DISTURBANCE DURING THE CONSTRUCTION PROCESS SHALL BE REPLACED AS NECESSARY AT NO COST TO THE TOWN OR OFFSITE PROPERTY OWNER.

CONCRETE FOR DRIVE-THRU LANE SHALL BE COLORED BLACK IN ACCORDANCE WITH ARBY'S STANDARDS.

SITE LIGHTING SHALL BE IN ACCORDANCE WITH PHOTOMETRIC PLAN DESIGNED BY OTHERS. LIGHT LEVELS SHALL AVERAGE BETWEEN 3-5 FOOT-CANDLES WITH NO PARKING AREAS BELOW 2 FC OR ABOVE 9 FC. MAXIMUM POLE HEIGHT PER ZONING IS 30 FEET.

SEE SIGNAGE PLAN BY OTHER FOR EXACT SIZE AND HEIGHT OF SIGNS, INCLUDING BUILDING SIGNAGE. SIGNAGE SHALL BE PERMITTED SEPARATELY.

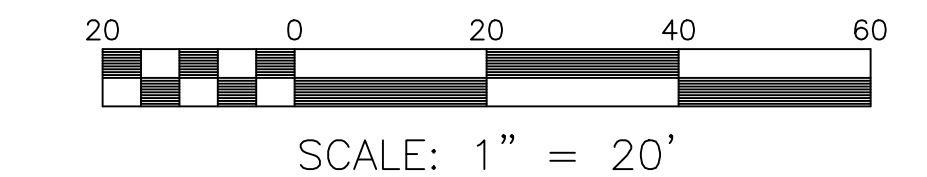

APPROVED: Engineering _____ Date _____

APPROVED: Planning _____ Date _____



REFLECTING TOMORROW
www.balzer.cc
New River Valley
Roanoke
Richmond
Staunton
Harrisonburg
Lynchburg
RESIDENTIAL LAND DEVELOPMENT ENGINEERING
SITE DEVELOPMENT ENGINEERING
LAND USE PLANNING & ZONING
LANDSCAPE ARCHITECTURE
LAND SURVEYING
ARCHITECTURE
STRUCTURAL ENGINEERING
TRANSPORTATION ENGINEERING
ENVIRONMENTAL & SOIL SCIENCE
WETLAND DELINEATIONS & STREAM EVALUATIONS
Balzer and Associates, Inc.
448 Peppers Ferry Road, NW
Christiansburg, VA 24073
540-381-4290
FAX 540-381-4291

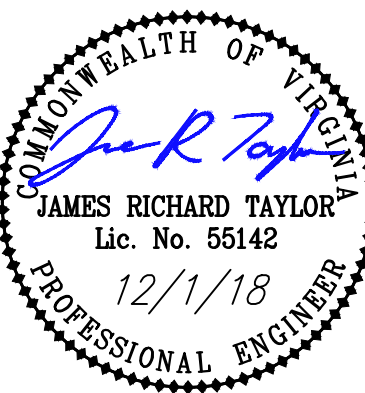

ARBY'S #8156
2650 MARKET STREET N.E.
LAYOUT AND DIMENSIONAL PLAN
SHAWSVILLE MAGISTERIAL DISTRICT
TOWN OF CHRISTIANBURG, VIRGINIA

DRAWN BY JRT
DESIGNED BY JRT
CHECKED BY SMS
DATE 11/1/18
SCALE 1" = 20'
REVISIONS:
12/1/18